

FOR INDEX OF SHEETS, SEE SHEET NO. 2

FOR LIST OF HIGHWAY STANDARDS, SEE SHEET NO. 2

TRAFFIC DATA

DESIGN DESIGNATION:
C.H. 54 (BRIGGS ST.) = MINOR ARTERIAL

ADT:
DESIGN
C.H. 54 (BRIGGS ST.) = 22,200 (2040)

POSTED SPEED:
C.H. 54 (BRIGGS ST.) = 30 MPH

DESIGN SPEED:
C.H. 54 (BRIGGS ST.) = 35 MPH

WILL COUNTY DIVISION OF TRANSPORTATION

PROPOSED ROADWAY IMPROVEMENT PLANS

**COUNTY HIGHWAY 54 (BRIGGS STREET) RECONSTRUCTION
WASHINGTON STREET TO INTERSTATE 80**

SECTION 17-00053-19-FP

**WILL COUNTY
MFT FUNDS**

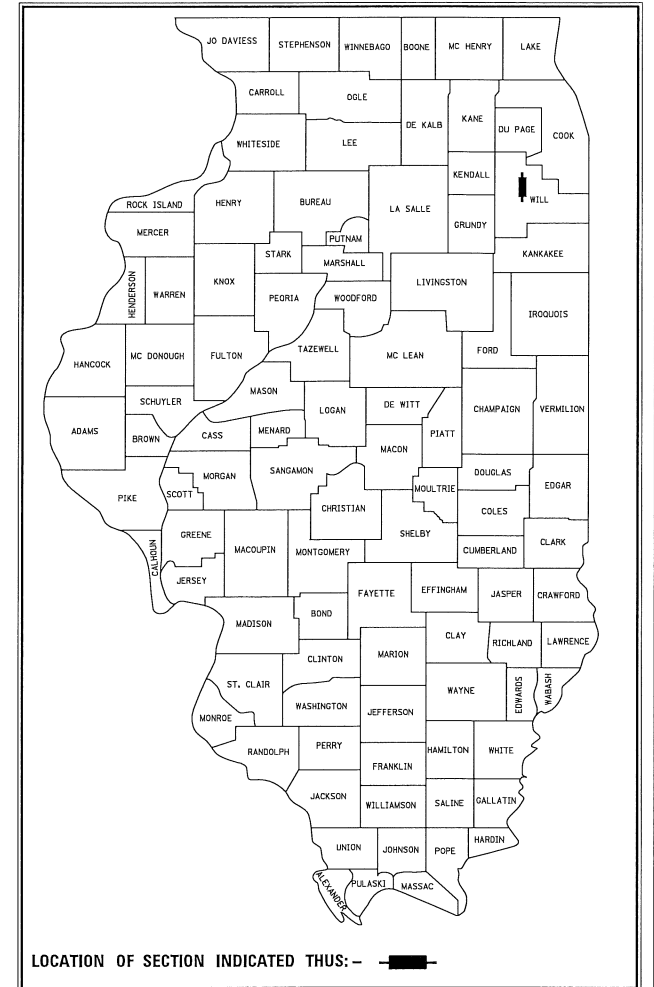

**BEGIN IMPROVEMENTS
SECTION 17-00053-19-FP
STA 988 + 97.87**

**BEGIN RECONSTRUCTION
SECTION 17-00053-19-FP
STA 1006 + 38.32**

**EXISTING STRUCTURE SN 099-3324
14 SPAN BRIDGE WITH STEEL
PLATE GIRDERS AND CONCRETE DECK
(VARIOUS BRIDGE REPAIRS)**

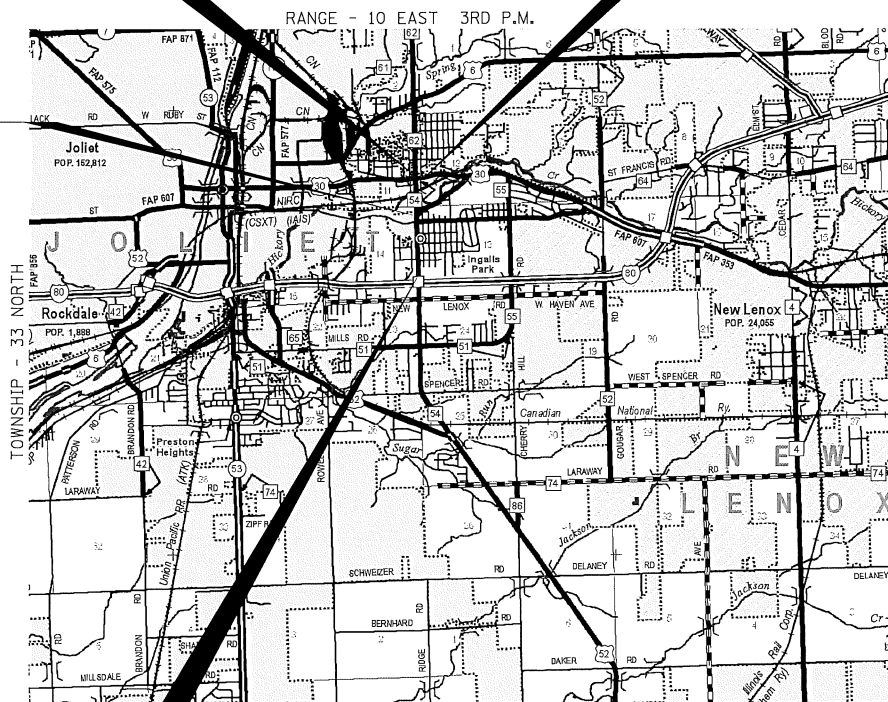

LOCATION MAP
(SCALE: 1" = 1 MILE)

**END IMPROVEMENTS
& RECONSTRUCTION
SECTION 17-00053-19-FP
STA 1035 + 63.00**

PROJECT GROSS AND NET LENGTH:
BRIGGS STREET 4665.13 FEET (0.89 MILES) GROSS
BRIGGS STREET 2924.68 FEET (0.56 MILES) NET

J.U.L.I.E. DIG NO:
JOINT UTILITY LOCATING INFORMATION FOR EXCAVATION
1-800-892-0123

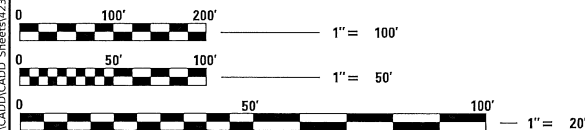

FULL SIZE PLANS HAVE BEEN PREPARED USING STANDARD ENGINEERING SCALES, REDUCED SIZED PLANS WILL NOT CONFORM TO STANDARD SCALES. IN MAKING MEASUREMENTS ON REDUCED PLANS, THE ABOVE SCALES MAY BE USED

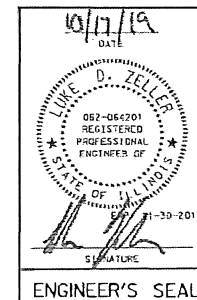

WILL COUNTY DIVISION OF TRANSPORTATION
APPROVED October 18 2019
Jeff Ronsleben
WILL COUNTY ENGINEER

Illinois Professional Design Firm # 184-000825
Hutchison Engineering, Inc.
Jacksonville - Peoria - Shorewood
Since 1945

MODEL: C:\p\win\... FILE NAME: V04237 - Briggs Street - North (WCDOT)\CAD\DCADD Sheets\4237-shr-cover.dgn

USER NAME = BDeCrane	DESIGNED -	REVISED -	WILL COUNTY DIVISION OF TRANSPORTATION C.H. 54 (BRIGGS STREET) RECONSTRUCTION WASHINGTON STREET TO INTERSTATE 80	C.H. 54 (BRIGGS ST) COVER SHEET			SECTION	COUNTY	TOTAL SHEETS	SHEET NO.
PLOT SCALE = 2,0000' / in.	DRAWN -	REVISED -		SCALE: N/A	SHEET 1	OF 1 SHEETS	CH 54	WILL	218	1
PLOT DATE = 12/18/2019	CHECKED -	REVISED -		STA. N/A	TO STA. N/A		CONTRACT NO.			
	DATE -	REVISED -					ILLINOIS FED. AID PROJECT			

SUMMARY OF QUANTITIES

ITEM NO.	SPECIALTY ITEM &/OR SPECIAL PROVISION	ITEM	UNIT	TOTAL QUANTITY
1		TREE REMOVAL (6 TO 15 UNITS DIAMETER)	UNIT	22
2		TREE TRUNK PROTECTION	EACH	4
3		EARTH EXCAVATION	CU YD	8276
4		TRENCH BACKFILL	CU YD	173
5		TOPSOIL FURNISH AND PLACE, 4"	SQ YD	3835
6		SEEDING, CLASS 4	ACRE	0.06
7		NITROGEN FERTILIZER NUTRIENT	POUND	83
8		PHOSPHORUS FERTILIZER NUTRIENT	POUND	83
9		POTASSIUM FERTILIZER NUTRIENT	POUND	83
10		MULCH, METHOD 2	ACRE	1.00
11		EROSION CONTROL BLANKET	SQ YD	313
12		SODDING, SALT TOLERANT	SQ YD	3522
13		SUPPLEMENTAL WATERING	UNIT	33
14		TEMPORARY EROSION CONTROL SEEDING	POUND	1050
15		PERIMETER EROSION BARRIER	FOOT	489
16		INLET AND PIPE PROTECTION	EACH	6
17		INLET FILTERS	EACH	52
18		STONE RIPRAP, CLASS A3	SQ YD	30
19		STONE RIPRAP, CLASS A5	TON	75
20		FILTER FABRIC	SQ YD	75
21		AGGREGATE SUBGRADE IMPROVEMENT 12"	SQ YD	17860
22		AGGREGATE BASE COURSE, TYPE B 3"	SQ YD	761
23		AGGREGATE BASE COURSE, TYPE B 6"	SQ YD	1359
24		AGGREGATE BASE COURSE, TYPE B 12"	SQ YD	423
25		AGGREGATE FOR TEMPORARY ACCESS	TON	1140
26		BITUMINOUS MATERIALS (TACK COAT)	POUND	10784
27		TEMPORARY RAMP	SQ YD	399
28		HOT-MIX ASPHALT BINDER COURSE, IL-19.0, N70	TON	17
29		HOT-MIX ASPHALT SURFACE COURSE, MIX "D", N70	TON	96
30		HOT-MIX ASPHALT PAVEMENT (FULL-DEPTH), 13"	SQ YD	15523
31		INCIDENTAL HOT-MIX ASPHALT SURFACING	TON	43
32		PROTECTIVE COAT	SQ YD	2642
33		PORTLAND CEMENT CONCRETE DRIVEWAY PAVEMENT, 6 INCH	SQ YD	1290
34		PORTLAND CEMENT CONCRETE DRIVEWAY PAVEMENT, 8 INCH	SQ YD	63
35		PORTLAND CEMENT CONCRETE SIDEWALK 5 INCH	SQ FT	5569
36		DETECTABLE WARNINGS	SQ FT	156
37		PAVEMENT REMOVAL	SQ YD	15378
38		HOT-MIX ASPHALT SURFACE REMOVAL, 1 1/2"	SQ YD	925
39		DRIVEWAY PAVEMENT REMOVAL	SQ YD	1342
40		COMBINATION CURB AND GUTTER REMOVAL	FOOT	6047

ITEM NO.	SPECIALTY ITEM &/OR SPECIAL PROVISION	ITEM	UNIT	TOTAL QUANTITY
41		SIDEWALK REMOVAL	SQ FT	8670
42		CLASS D PATCHES, TYPE I, 13 INCH	SQ YD	4
43		CONCRETE REMOVAL	CU YD	5.1
44		PIPE CULVERT REMOVAL	FOOT	76
45		CONCRETE SUPERSTRUCTURE	CU YD	5.1
46		REINFORCEMENT BARS, EPOXY COATED	POUND	710
47		BAR SPLICERS	EACH	8
48		PREFORMED JOINT STRIP SEAL	FOOT	128
49		PRECAST REINFORCED CONCRETE FLARED END SECTIONS, EQUIVALENT ROUND-SIZE 18"	EACH	1
50		STORM SEWERS, CLASS A, TYPE 1 12"	FOOT	423
51		STORM SEWERS, CLASS A, TYPE 1 15"	FOOT	303
52		STORM SEWERS, CLASS A, TYPE 1 18"	FOOT	97
53		STORM SEWERS, CLASS A, TYPE 2 12"	FOOT	573
54		STORM SEWERS, CLASS A, TYPE 2 15"	FOOT	484
55		STORM SEWERS, CLASS A, TYPE 2 24"	FOOT	475
56		STORM SEWERS, CLASS A, TYPE 1 EQUIVALENT ROUND-SIZE 18"	FOOT	123
57		STORM SEWERS, CLASS A, TYPE 1 EQUIVALENT ROUND-SIZE 24"	FOOT	360
58		STORM SEWER REMOVAL 12"	FOOT	1593
59		STORM SEWER REMOVAL 15"	FOOT	337
60		STORM SEWER REMOVAL 18"	FOOT	345
61		STORM SEWER REMOVAL 24"	FOOT	179
62	SP	CONTROLLED LOW-STRENGTH MATERIAL	CU YD	878.0
63		CATCH BASINS, TYPE A, 4'-DIAMETER, TYPE 24 FRAME AND GRATE	EACH	9
64		MANHOLES, TYPE A, 4'-DIAMETER, TYPE 1 FRAME, OPEN LID	EACH	2
65		MANHOLES, TYPE A, 4'-DIAMETER, TYPE 1 FRAME, CLOSED LID	EACH	13
66		MANHOLES, TYPE A, 4'-DIAMETER, TYPE 8 GRATE	EACH	2
67		MANHOLES, TYPE A, 5'-DIAMETER, TYPE 1 FRAME, CLOSED LID	EACH	1
68		MANHOLES, TYPE A, 6'-DIAMETER, TYPE 1 FRAME, CLOSED LID	EACH	1
69		INLETS, TYPE A, TYPE 8 GRATE	EACH	2
70		INLETS, TYPE A, TYPE 24 FRAME AND GRATE	EACH	27
71		INLETS, TYPE B, TYPE 8 GRATE	EACH	2
72		INLETS, TYPE B, TYPE 24 FRAME AND GRATE	EACH	7
73		CATCH BASINS TO BE ADJUSTED WITH NEW TYPE 24 FRAME AND GRATE	EACH	2
74		MANHOLES TO BE ADJUSTED WITH NEW TYPE 1 FRAME, CLOSED LID	EACH	2
75		MANHOLES TO BE ADJUSTED WITH NEW TYPE 24 FRAME AND GRATE	EACH	4
76		INLETS TO BE ADJUSTED WITH NEW TYPE 24 FRAME AND GRATE	EACH	2
77		VALVE VAULTS TO BE ADJUSTED	EACH	2
78		REMOVING MANHOLES	EACH	8
79		REMOVING INLETS	EACH	24
80		COMBINATION CONCRETE CURB AND GUTTER, TYPE B-6.24	FOOT	6013

SP=SPECIAL PROVISION SI=SPECIALITY ITEM BDE=BUREAU OF DESIGN AND ENVIRONMENT GBSP=GUIDE BRIDGE SPECIAL PROVISION

USER NAME = BWedemeler	DESIGNED -	REVISED -
PLOT SCALE = 2,000' / in.	DRAWN -	REVISED -
PLOT DATE = 1/14/2020	CHECKED -	REVISED -
	DATE -	REVISED -

**WILL COUNTY DIVISION OF TRANSPORTATION
CH 54 (BRIGGS STREET) RECONSTRUCTION
WASHINGTON STREET TO INTERSTATE 80**

**C.H. 54 (BRIGGS ST.)
SUMMARY OF QUANTITIES**

SCALE: N/A SHEET 1 OF 3 SHEETS STA. N/A TO STA. N/A

RTE. NO. CH 54	SECTION 17-00053-19-FP	COUNTY WILL	TOTAL SHEETS 218	SHEET NO. 3
CONTRACT NO.				
ILLINOIS FED. AID PROJECT				

MODEL: Default
FILE NAME: V:\237 - Briggs Street - North (WCDOT)\CADD\CADD Sheets\237-shs-SQC-1.dgn

SUMMARY OF QUANTITIES

ITEM NO.	SPECIALTY ITEM &/OR SPECIAL PROVISION	ITEM	UNIT	TOTAL QUANTITY
81		NON-SPECIAL WASTE DISPOSAL	CU YD	396
82		SOIL DISPOSAL ANALYSIS	EACH	1
83		REGULATED SUBSTANCES PRE-CONSTRUCTION PLAN	L SUM	1
84		REGULATED SUBSTANCES FINAL CONSTRUCTION REPORT	L SUM	1
85		REGULATED SUBSTANCES MONITORING	CAL DA	10
86		MOBILIZATION	L SUM	1
87		CHANGEABLE MESSAGE SIGN	CAL DA	56
88		SHORT TERM PAVEMENT MARKING	FOOT	7500
89		SHORT TERM PAVEMENT MARKING REMOVAL	SQ FT	1250
90	SP	TEMPORARY PAVEMENT MARKING LETTERS AND SYMBOLS	SQ FT	210.2
91	SP	TEMPORARY PAVEMENT MARKING - LINE 4"	FOOT	84588
92	SP	TEMPORARY PAVEMENT MARKING - LINE 24"	FOOT	775
93		SIGN PANEL - TYPE 1	SQ FT	237
94		SIGN PANEL - TYPE 2	SQ FT	20
95		REMOVE SIGN PANEL ASSEMBLY - TYPE A	EACH	29
96		RELOCATE SIGN PANEL - TYPE 1	SQ FT	32
97		TELESCOPING STEEL SIGN SUPPORT	FOOT	604
98	SI	THERMOPLASTIC PAVEMENT MARKING - LETTERS AND SYMBOLS	SQ FT	629.2
99	SI	THERMOPLASTIC PAVEMENT MARKING - LINE 4"	FOOT	15493
100	SI	THERMOPLASTIC PAVEMENT MARKING - LINE 6"	FOOT	1536
101	SI	THERMOPLASTIC PAVEMENT MARKING - LINE 12"	FOOT	955
102	SI	THERMOPLASTIC PAVEMENT MARKING - LINE 24"	FOOT	176
103	SI	POLYUREA PAVEMENT MARKING TYPE I - LETTERS AND SYMBOLS	SQ FT	582.4
104	SI	POLYUREA PAVEMENT MARKING TYPE I - LINE 4"	FOOT	25889
105	SI	POLYUREA PAVEMENT MARKING TYPE I - LINE 6"	FOOT	2955
106	SI	POLYUREA PAVEMENT MARKING TYPE I - LINE 12"	FOOT	390
107	SI	POLYUREA PAVEMENT MARKING TYPE I - LINE 24"	FOOT	218
108	SI	RAISED REFLECTIVE PAVEMENT MARKER	EACH	156
109		RAISED REFLECTIVE PAVEMENT MARKER REMOVAL	EACH	114
110	SI, SP	SERVICE INSTALLATION - POLE MOUNTED	EACH	1
111	SI, SP	UNDERGROUND CONDUIT, GALVANIZED STEEL, 2" DIA.	FOOT	386
112	SI, SP	UNDERGROUND CONDUIT, GALVANIZED STEEL, 2 1/2" DIA.	FOOT	39
113	SI, SP	UNDERGROUND CONDUIT, GALVANIZED STEEL, 3" DIA.	FOOT	116
114	SI, SP	UNDERGROUND CONDUIT, GALVANIZED STEEL, 4" DIA.	FOOT	372
115	SI, SP	HANDHOLE	EACH	4
116	SI, SP	HEAVY-DUTY HANDHOLE	EACH	2
117	SI, SP	DOUBLE HANDHOLE	EACH	1
118	SI	MAINTENANCE OF EXISTING TRAFFIC SIGNAL INSTALLATION	EACH	1
119	SI, SP	ELECTRIC CABLE IN CONDUIT, SIGNAL NO. 14 2C	FOOT	1266
120	SI, SP	ELECTRIC CABLE IN CONDUIT, SIGNAL NO. 14 3C	FOOT	1631

ITEM NO.	SPECIALTY ITEM &/OR SPECIAL PROVISION	ITEM	UNIT	TOTAL QUANTITY
121	SI, SP	ELECTRIC CABLE IN CONDUIT, SIGNAL NO. 14 5C	FOOT	1247
122	SI, SP	ELECTRIC CABLE IN CONDUIT, SIGNAL NO. 14 7C	FOOT	1561
123	SI, SP	ELECTRIC CABLE IN CONDUIT, LEAD-IN, NO. 14 1 PAIR	FOOT	1335
124	SI, SP	ELECTRIC CABLE IN CONDUIT, SERVICE, NO. 6 2 C	FOOT	36
125	SI, SP	ELECTRIC CABLE IN CONDUIT, EQUIPMENT GROUNDING CONDUCTOR, NO. 6 1C	FOOT	750
126	SI, SP	TRAFFIC SIGNAL POST, GALVANIZED STEEL 16 FT.	EACH	3
127	SI, SP	STEEL MAST ARM ASSEMBLY AND POLE, 42 FT.	EACH	1
128	SI, SP	STEEL MAST ARM ASSEMBLY AND POLE, 48 FT.	EACH	1
129	SI, SP	CONCRETE FOUNDATION, TYPE A	FOOT	12
130	SI, SP	CONCRETE FOUNDATION, TYPE E 36-INCH DIAMETER	FOOT	26
131	SI, SP	DRILL EXISTING HANDHOLE	EACH	6
132	SI, SP	SIGNAL HEAD, LED, 1-FACE, 3-SECTION, MAST-ARM MOUNTED	EACH	6
133	SI, SP	SIGNAL HEAD, LED, 1-FACE, 5-SECTION, BRACKET MOUNTED	EACH	4
134	SI, SP	SIGNAL HEAD, LED, 1-FACE, 5-SECTION, MAST-ARM MOUNTED	EACH	4
135	SI, SP	TRAFFIC SIGNAL BACKPLATE, LOUVERED, FORMED PLASTIC	EACH	10
136	SI, SP	INDUCTIVE LOOP DETECTOR	EACH	5
137	SI, SP	DETECTOR LOOP, TYPE I	FOOT	330
138	SI	TEMPORARY TRAFFIC SIGNAL INSTALLATION	EACH	2
139	SI	RELOCATE EXISTING PEDESTRIAN SIGNAL HEAD	EACH	8
140	SI	RELOCATE EXISTING PEDESTRIAN PUSH-BUTTON	EACH	8
141	SI	RELOCATE EXISTING EMERGENCY VEHICLE PRIORITY SYSTEM, DETECTOR UNIT	EACH	2
142	SI	MODIFY EXISTING CONTROLLER	EACH	1
143	SI	MODIFY EXISTING CONTROLLER CABINET	EACH	1
144	SI	REMOVE ELECTRIC CABLE FROM CONDUIT	FOOT	5800
145	SI	REMOVE AND REINSTALL ELECTRIC CABLE FROM CONDUIT	FOOT	295
146	SI	REMOVE EXISTING TRAFFIC SIGNAL EQUIPMENT	EACH	1
147	SI	REMOVE EXISTING HANDHOLE	EACH	7
148	SI	REMOVE EXISTING DOUBLE HANDHOLE	EACH	2
149	SI	REMOVE EXISTING CONCRETE FOUNDATION	EACH	6
150	SI, SP	EMERGENCY VEHICLE PRIORITY SYSTEM LINE SENSOR CABLE, NO. 20 3/C	FOOT	312
151	SP	PLUG EXISTING STORM SEWERS	CU YD	0.2
152	SP	TEMPORARY CONNECTION TO EXISTING STORM SEWER	EACH	12
153	SP	TEMPORARY PATCHING	SQ YD	13
154	SI	PAVEMENT MARKING REMOVAL - WATER BLASTING	SQ FT	3411
155	SI, SP	VIDEO VEHICLE DETECTION SYSTEM, SINGLE APPROACH	EACH	2
156	SP	FENCE (SPECIAL)	FOOT	276
157	GBSP	BRIDGE CLEANING AND PAINTING WARRANTY	L SUM	1
158	SP	PIPE UNDERDRAINS 4" (MODIFIED)	FOOT	204
159	SP	SANITARY MANHOLES TO BE ADJUSTED WITH NEW TYPE 1 FRAME, CLOSED LID	EACH	11
160	SP	TRAFFIC CONTROL AND PROTECTION (SPECIAL)	L SUM	1

SP=SPECIAL PROVISION SI=SPECIALTY ITEM BDE=BUREAU OF DESIGN AND ENVIRONMENT GBSP=GUIDE BRIDGE SPECIAL PROVISION

USER NAME = BWedemeler	DESIGNED -	REVISED -
PLOT SCALE = 2,000' / In.	DRAWN -	REVISED -
PLOT DATE = 1/14/2020	CHECKED -	REVISED -
	DATE -	REVISED -

**WILL COUNTY DIVISION OF TRANSPORTATION
CH 54 (BRIGGS STREET) RECONSTRUCTION
WASHINGTON STREET TO INTERSTATE 80**

**C.H. 54 (BRIGGS ST.)
SUMMARY OF QUANTITIES**

SCALE: N/A SHEET 2 OF 3 SHEETS STA. N/A TO STA. N/A

RTE. NO. CH 54	SECTION 17-00053-19-FP	COUNTY WILL	TOTAL SHEETS 218	SHEET NO. 4
CONTRACT NO.				
ILLINOIS FED. AID PROJECT				

MODEL - Default
FILE NAME: Y:\4237 - Briggs Street - North (WCDOT)\CADD\CADD Sheets\4237-Int-SQ-2.dgn

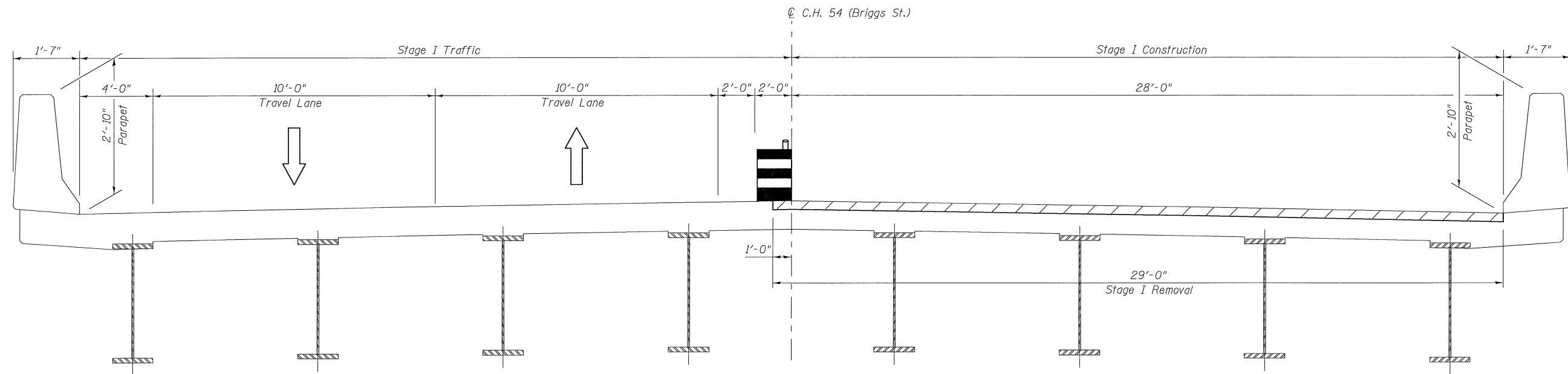

STAGE I LOOKING SOUTH
 (South End of Bridge Shown, North End Similar)

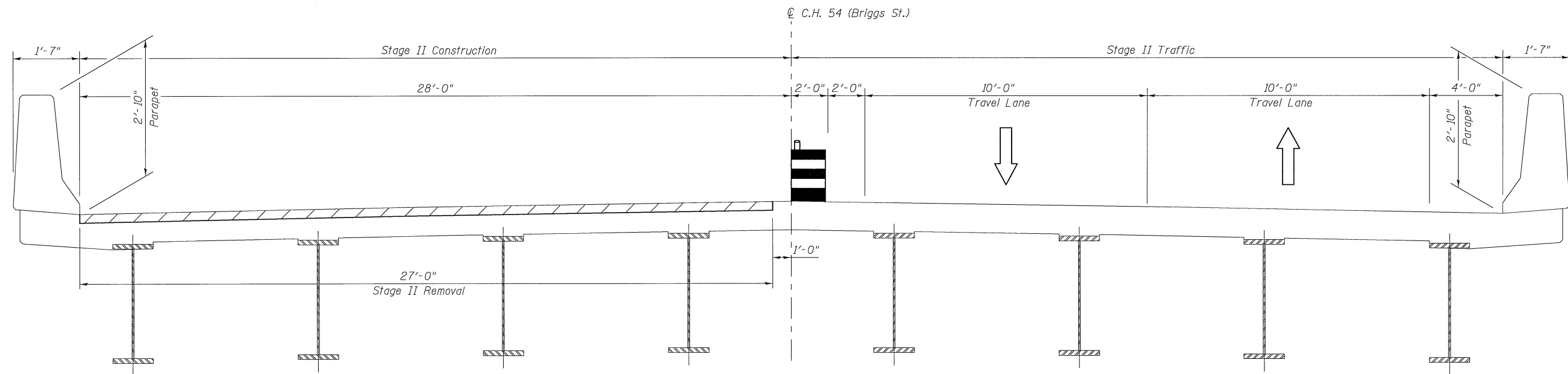

STAGE II LOOKING SOUTH
 (South End of Bridge Shown, North End Similar)

Hutchison Engineering, Inc. JACKSONVILLE-SHOREWOOD-PEORIA-MOLINE	USER NAME =	DESIGNED - JOH	REVISED -	WILL COUNTY DIVISION OF TRANSPORTATION	BRIGGS ST. OVER HICKORY CREEK & METRA RAILROAD STAGE CONSTRUCTION DETAILS	FAU	SECTION	COUNTY	TOTAL	SHEET
	PLOT SCALE = NONE	CHECKED - BAN	REVISED -			363	17-00053-19-FP	WILL	218	165
	PLOT DATE =	DRAWN - JCW	REVISED -			S.N. 099-3324		CONTRACT NO.		
		CHECKED - JOH/BAN	REVISED -			SHEET NO. 2 OF 23 SHEETS		ILLINOIS FED. AID PROJECT		

V:\4237 - Briggs Street - North (WCDOT)\CADD\CADD Sheets\4237b002.dgn

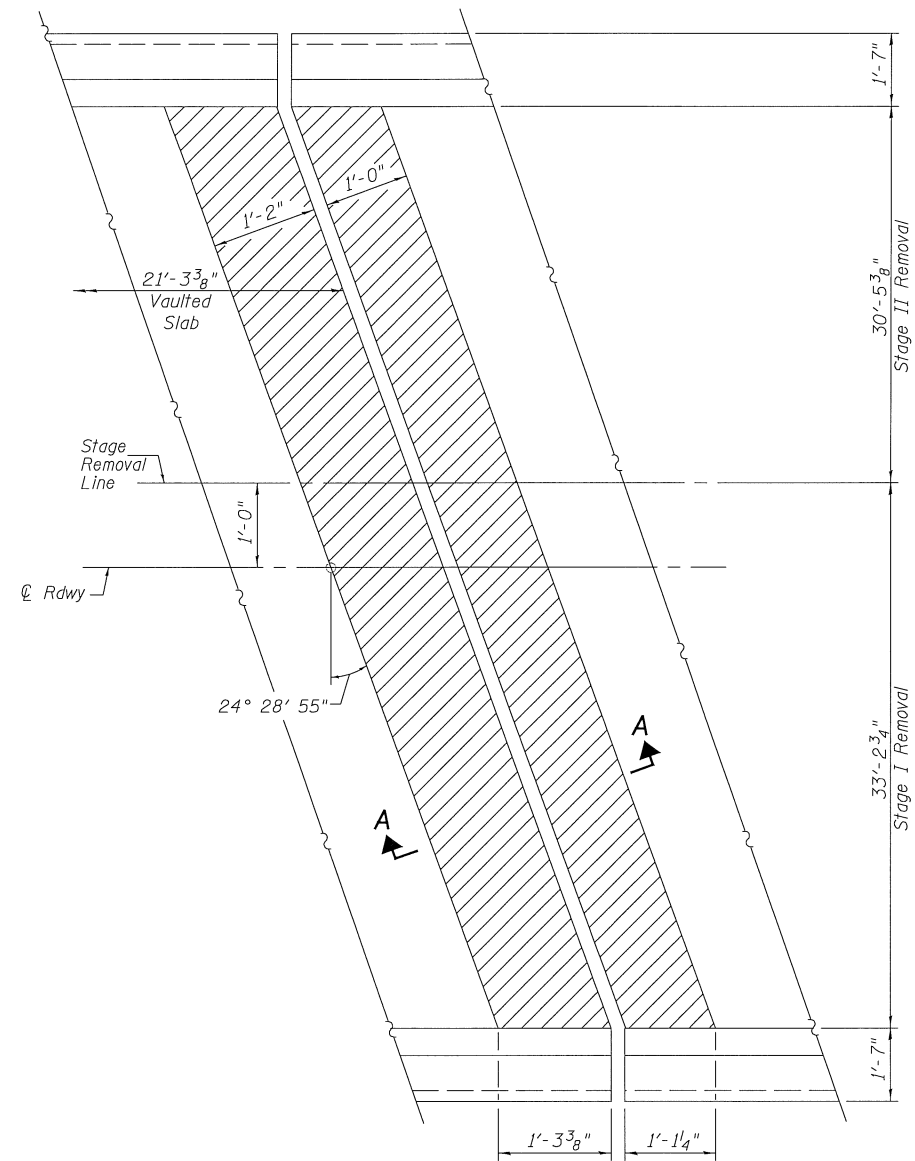

Notes:
 Hatched area indicates concrete removal.
 See Sht. 5 of 23 for Sections A-A and B-B.
 Removal of Existing Joints included in cost of concrete removal.

EXISTING PLAN
 (North Abutment)

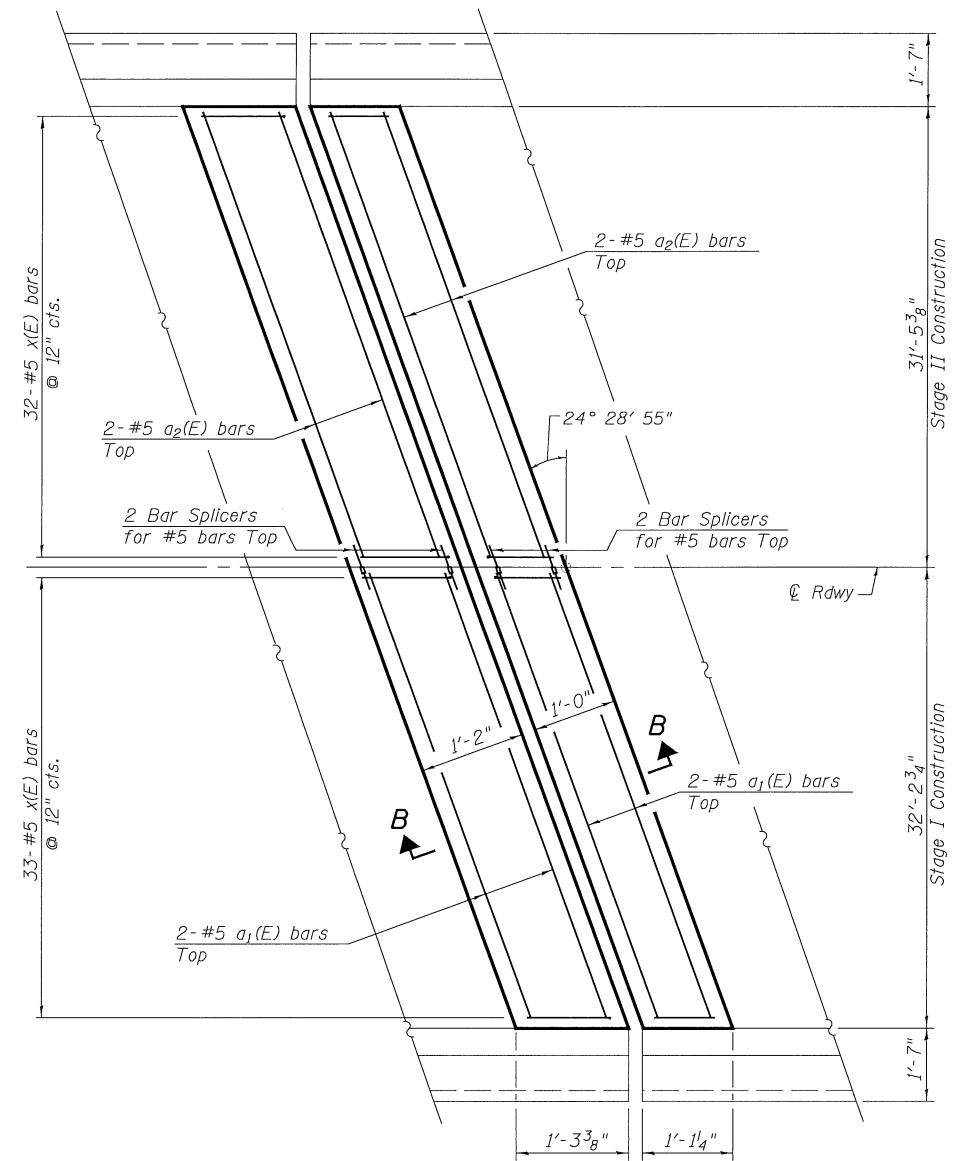
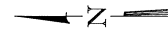

PROPOSED PLAN
 (North Abutment)

Hutchison Engineering, Inc.
 JACKSONVILLE-SHOREWOOD-PEORIA-MOLINE

USER NAME =
 PLOT SCALE = NONE
 PLOT DATE =

DESIGNED - JOH
 CHECKED - BAN
 DRAWN - JCW
 CHECKED - JOH/BAN

REVISED -
 REVISED -
 REVISED -
 REVISED -

WILL COUNTY
DIVISION OF TRANSPORTATION

BRIGGS ST. OVER HICKORY CREEK & METRA RAILROAD
NORTH EXPANSION JOINT REPLACEMENT DETAILS

SHEET NO. 3 OF 23 SHEETS

FAU RTE	SECTION	COUNTY	TOTAL SHEETS	SHEET NO.
363	17-00053-19-FP	WILL	218	166
S.N. 099-3324			CONTRACT NO.	
ILLINOIS FED. AID PROJECT				

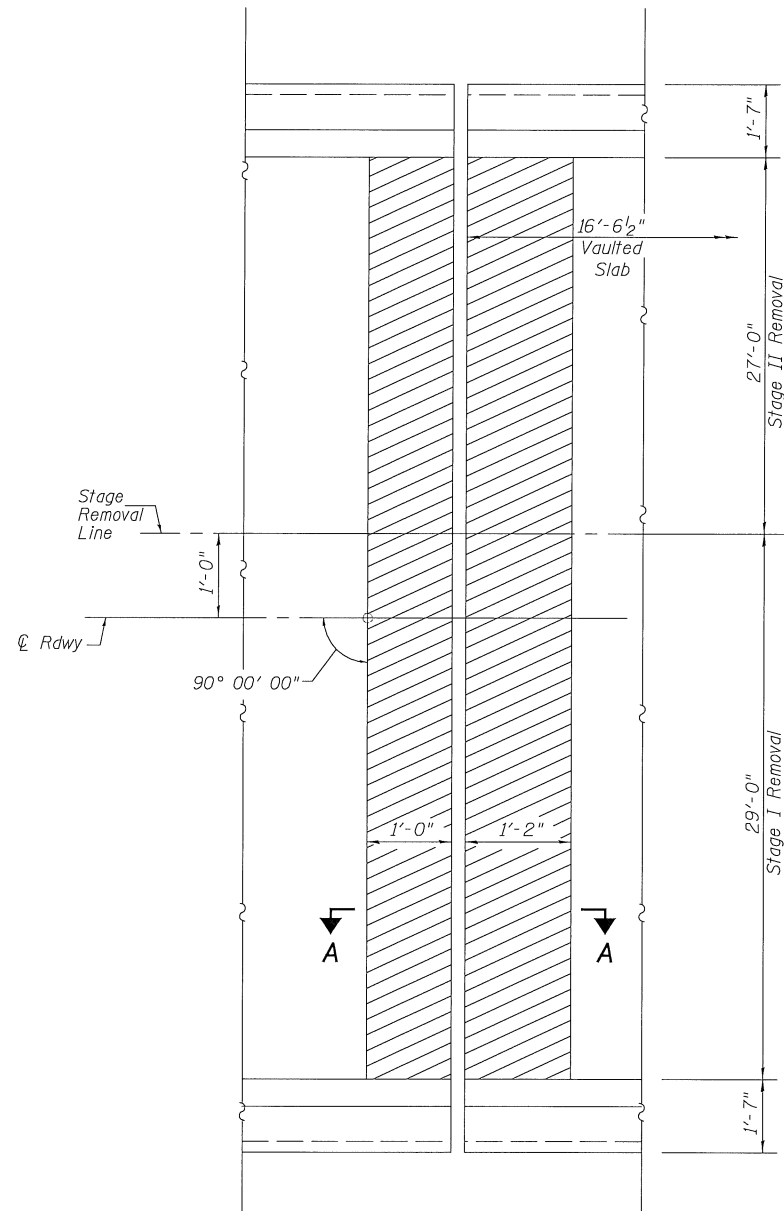

EXISTING PLAN
(South Abutment)

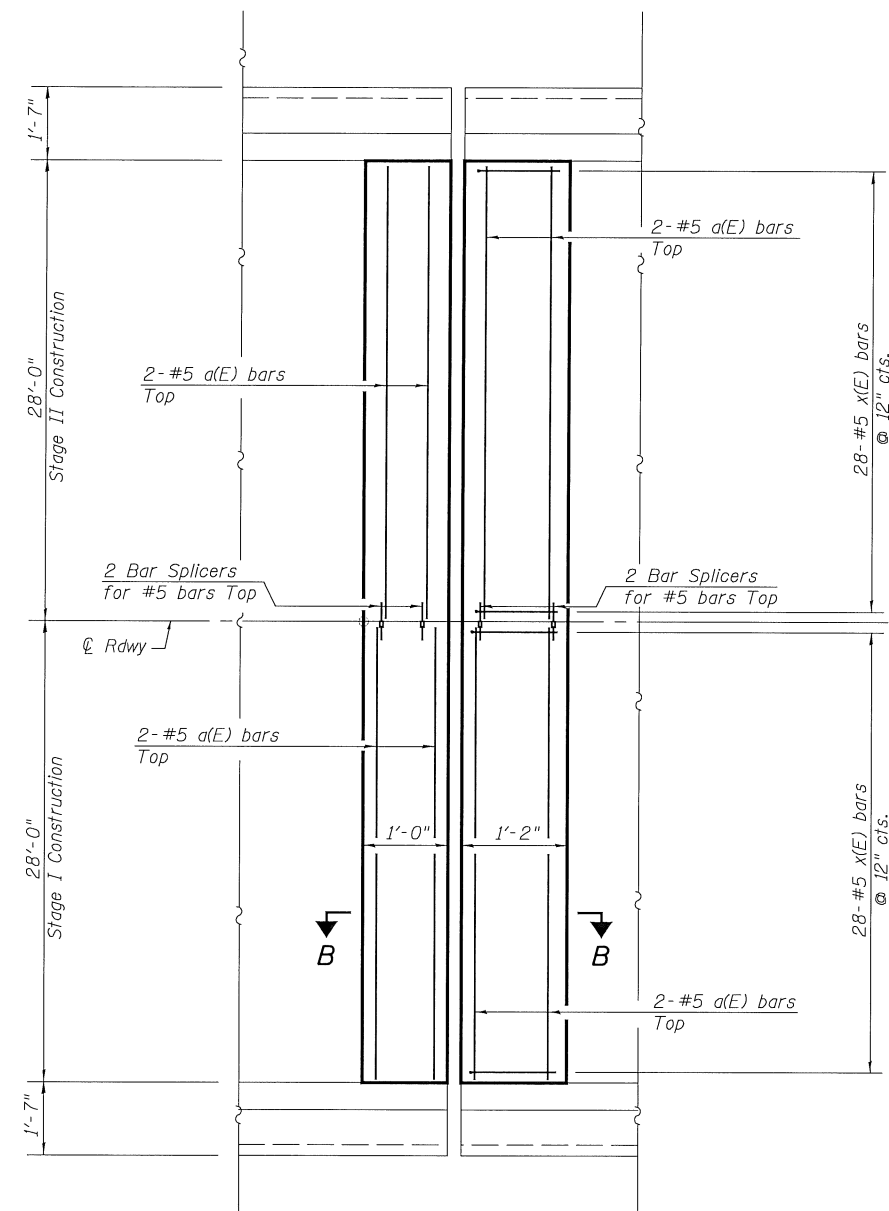

PROPOSED PLAN
(South Abutment)

Notes:

Hatched area indicates concrete removal.
See Sht. 5 of 23 for Sections A-A and B-B.
Removal of Existing Joints included in cost of concrete removal.

Hutchison Engineering, Inc.
JACKSONVILLE-SHOREWOOD-PEORIA-MOLINE

USER NAME =	DESIGNED - JOH	REVISED -
PLOT SCALE = NONE	CHECKED - BAN	REVISED -
PLOT DATE =	DRAWN - JCW	REVISED -
	CHECKED - JOH/BAN	REVISED -

WILL COUNTY
DIVISION OF TRANSPORTATION

BRIGGS ST. OVER HICKORY CREEK & METRA RAILROAD
SOUTH EXPANSION JOINT REPLACEMENT DETAILS

FAU RTE	SECTION	COUNTY	TOTAL SHEETS	SHEET NO.
363	17-00053-19-FP	WILL	218	167
S.N. 099-3324			CONTRACT NO.	
ILLINOIS FED. AID PROJECT				

SHEET NO. 4 OF 23 SHEETS

* Drill and grout #5 x(E) bars according to Section 584 of the Standard Specifications. Depth shall be 6".

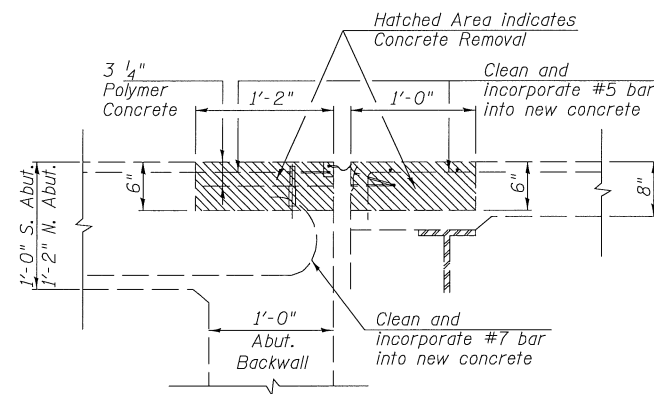

**EXISTING STRIP SEAL EXPANSION JOINT
AT ABUTMENTS
SECTION A-A**

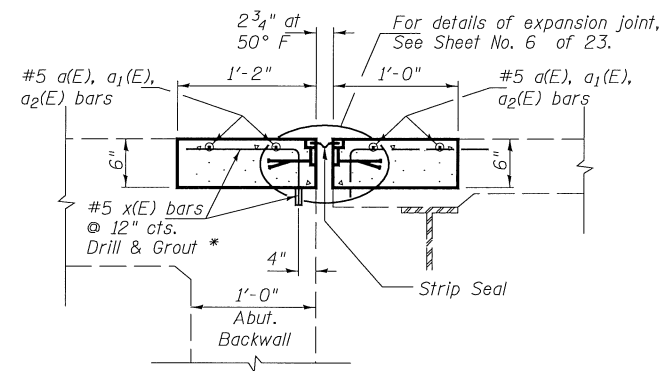

**PROPOSED STRIP SEAL EXPANSION JOINT
AT ABUTMENTS
SECTION B-B**

BILL OF MATERIAL

BAR	NO.	SIZE	LENGTH	SHAPE
a(E)	8	#5	27'-9"	—
a1(E)	4	#5	35'-1"	—
a2(E)	4	#5	34'-3"	—
x(E)	121	#5	1'-6"	└
ITEM		UNIT	QUANTITY	
Concrete Removal		CU YD	5.1	
Concrete Superstructure Reinforcement Bars, Epoxy Coated Preformed Joint		CU YD	5.1	
Strip Seal		FOOT	128	
Bar Splicers		EACH	8	

Notes:

Joint openings shall be adjusted according to Art. 520.04 of the Standard Specifications when the joint is installed at an ambient temperature other than 50° F.

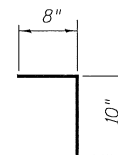

BAR x(E)

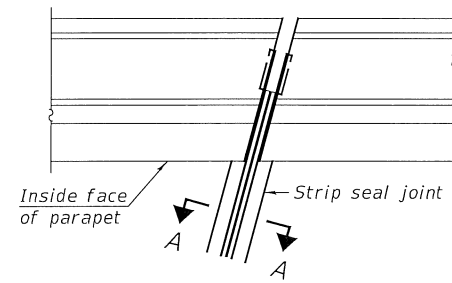

FOR SKEWS $\leq 30^\circ$
PLAN AT PARAPET

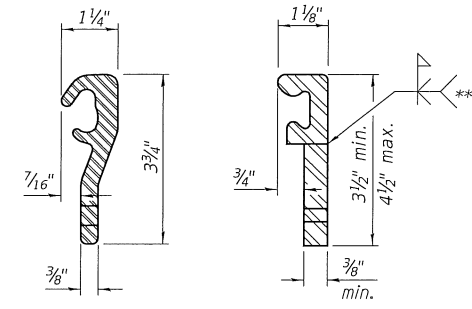

ROLLED (EXTRUDED) RAIL WELDED RAIL

LOCKING EDGE RAILS

** Back gouge not required if complete joint penetration is verified by mock-up.

Notes:
The strip seal shall be made continuous and shall have a minimum thickness of $\frac{1}{4}$ ". The configuration of the strip seal shall match the configuration of the locking edge rails. Open or "webbed" strip seal gland configurations are not permitted. The gland shall be sized for a maximum rated movement of 4 inches.

The locking edge rails depicted are configured for typical applications and are conceptual only. The actual configuration of the locking edge rails and matching strip seal may vary from manufacturer to manufacturer provided they fit the application and meet the minimum anchorage shown. Flanged edge rails, however, will not be allowed. Locking edge rails may exceed the $4\frac{1}{2}$ " maximum depth (but may not exceed 6") provided the anchorage system is revised according to the manufacturer's recommendation.

The manufacturer's recommended installation methods shall be followed.

All steel components shall be galvanized after fabrication according to Article 520.03 of the Standard Specifications.

The Maximum space between locking edge rail segments shall be $\frac{3}{16}$ " and sealed with a suitable sealant; however, any rail joint within 10' measured perpendicular to the face of the curb or parapet shall be welded as shown in the locking edge rail splice detail.

34" F-shape barrier shown, 42" F-shape similar as noted.

The concrete opening below the strip seal will vary based on the locking edge rail chosen by the Contractor. Deck and parapet lengths shown elsewhere in the plans are dimensioned to the concrete opening, not the joint opening, and are based on the rolled locking edge rail. If the Contractor elects to use a different locking edge rail, dimensional adjustments may be required. One exception to this would be the strip seal joint at the end of the precast bridge approach slab. For these cases the pavement connector length shall be adjusted, not the length of the bridge approach slab.

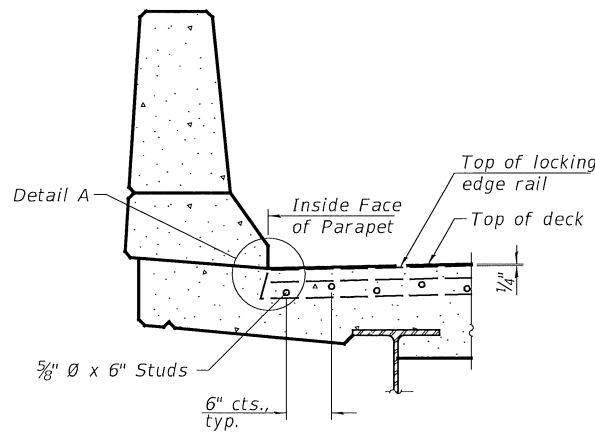

ELEVATION AT PARAPET (PROPOSED)

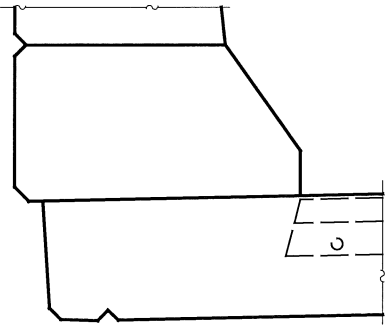

DETAIL A

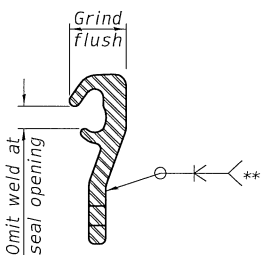

LOCKING EDGE RAIL SPLICE

The inside of the locking edge rail groove shall be free of weld residue. Rolled rail shown, welded rail similar.

BILL OF MATERIAL

ITEM	UNIT	TOTAL
Preformed Joint Strip Seal	FOOT	128

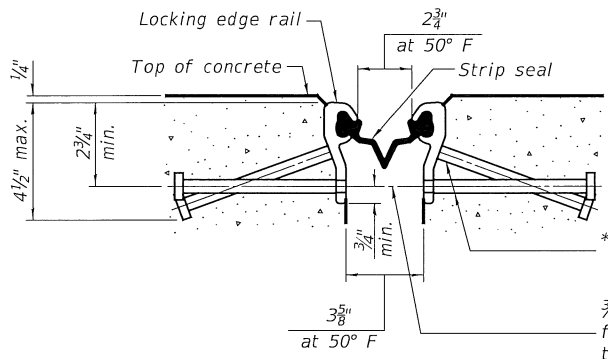

SHOWING ROLLED RAIL JOINT

* $\frac{5}{8}$ " ϕ x 6" studs @ 6" cts. (alternate angled/bent studs with horizontal studs)
 $\frac{3}{8}$ " ϕ threaded rods in $\frac{1}{16}$ " ϕ holes at $\pm 4'-0"$ cts. for holding the proper joint opening based on the temperature during the deck pour. Place to miss studs. All rods shall be burned, or sawed off flush with the plates after concrete is set.

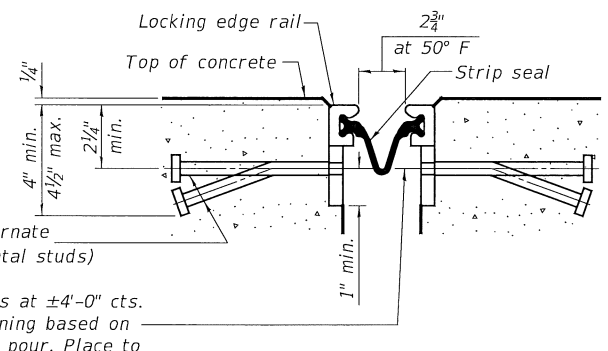

SHOWING WELDED RAIL JOINT

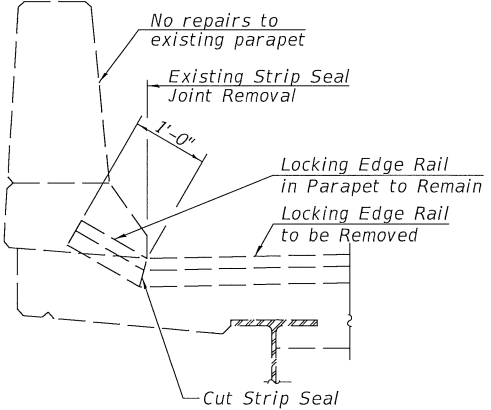

SECTION A-A

* Granular or solid flux filled headed studs conforming to Article 1006.32 of the Std. Specs., automatically end welded.



ELEVATION AT PARAPET (EXISTING)

LEGEND

-  Deck Slab Repair (Partial Depth)
-  Structural Repair of Concrete (Depth Equal or Less Than 5 Inches)
- SF Square Feet

Notes:
 Deck condition survey performed May 2019.
 Repair of the existing deck shall include but not be limited to the areas shown. The actual areas to be repaired will be determined by the Engineer at the time of construction. See sheet 20 of 23 for Bill of Materials.

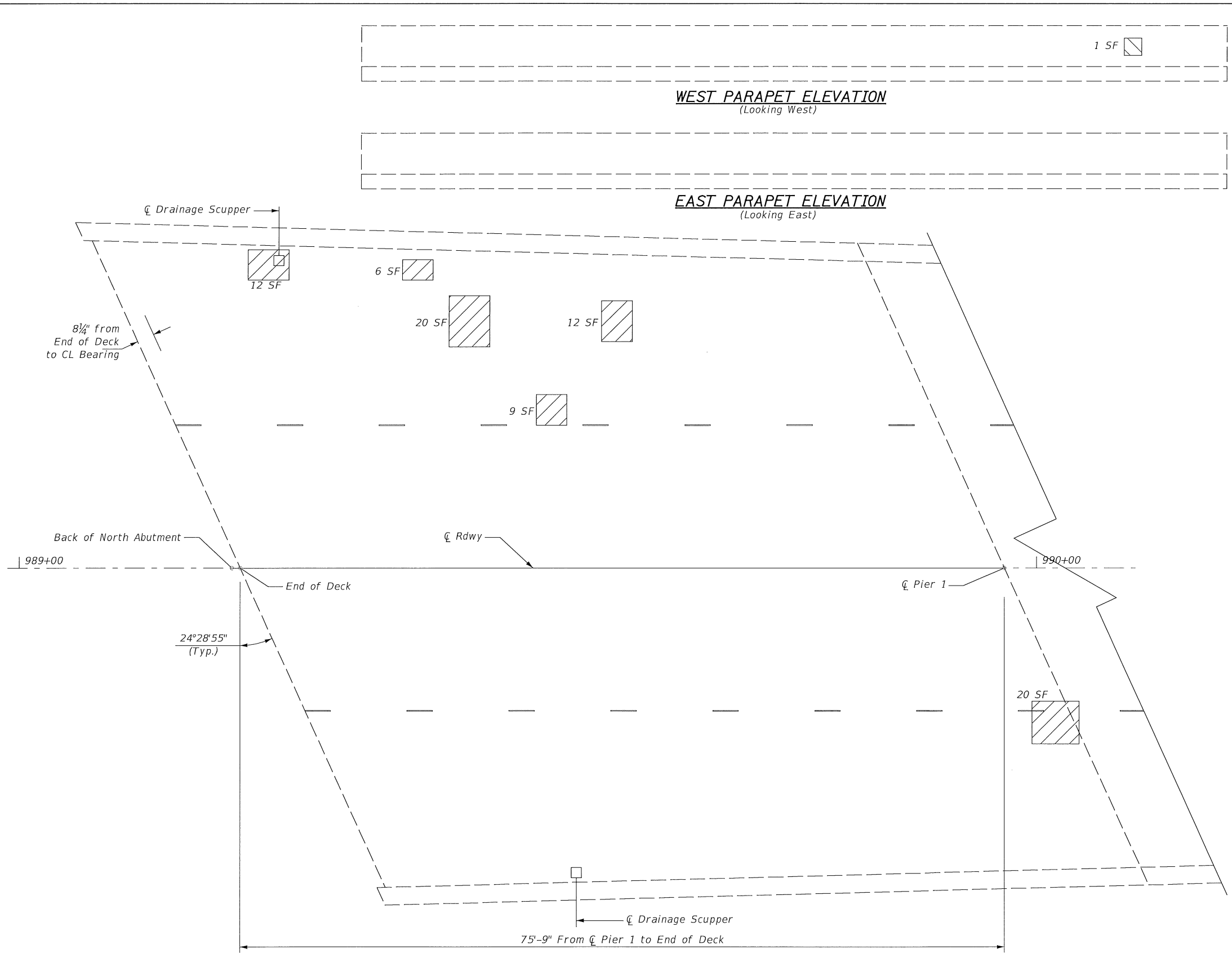

Note: All dimensions were taken from as built plans

Hutchison Engineering, Inc.
 JACKSONVILLE-SHOREWOOD-PEORIA-MOLINE

USER NAME =	DESIGNED - CTM	REVISED -
PLOT SCALE = NONE	CHECKED - BAN	REVISED -
PLOT DATE =	DRAWN - JCW	REVISED -
	CHECKED - CTM/BAN	REVISED -



WILL COUNTY
DIVISION OF TRANSPORTATION

BRIGGS ST. OVER HICKORY CREEK & METRA RAILROAD
DECK SLAB REPAIR - SPAN 1

FAU	SECTION	COUNTY	TOTAL SHEETS	SHEET NO.
363	17-00053-19-FP	WILL	218	170
S.N. 099-3324			CONTRACT NO.	
ILLINOIS FED. AID PROJECT				

SHEET NO. 7 OF 23 SHEETS

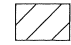
LEGEND

-  Deck Slab Repair (Partial Depth)
-  Structural Repair of Concrete (Depth Equal or Less Than 5 Inches)
- SF Square Feet

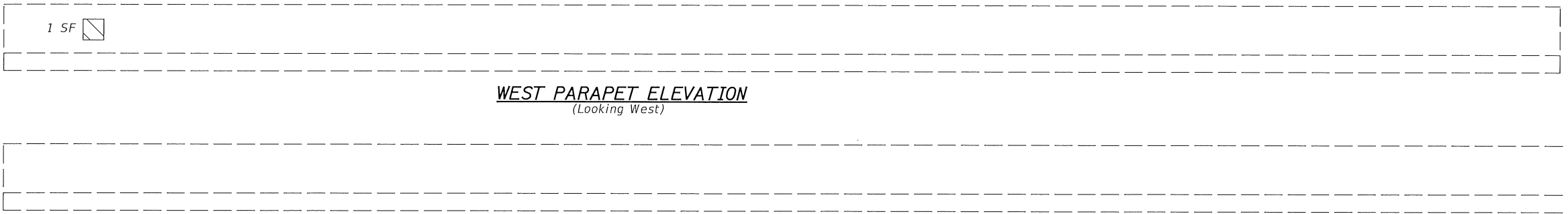

WEST PARAPET ELEVATION
(Looking West)

EAST PARAPET ELEVATION
(Looking East)

Notes:
Deck condition survey performed May 2019.
Repair of the existing deck shall include but not be limited to the areas shown. The actual areas to be repaired will be determined by the Engineer at the time of construction.
See sheet 20 of 23 for Bill of Materials.

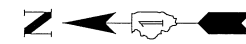
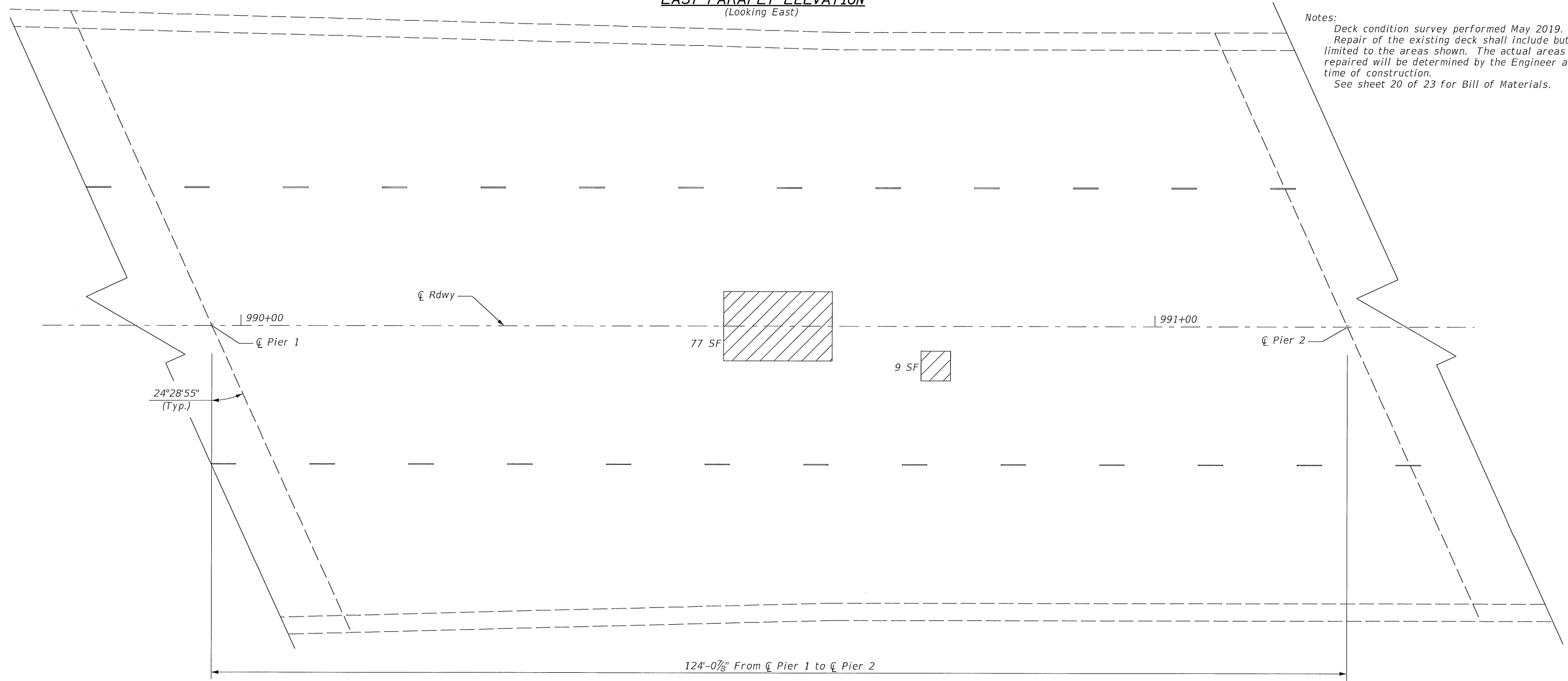

Note: All dimensions were taken from as built plans

SPAN 2 PLAN

<p>Hutchison Engineering, Inc. JACKSONVILLE-SHOREWOOD-PEORIA-MOLINE</p>	USER NAME =	DESIGNED -- CTM	REVISED --	<p>WILL COUNTY DIVISION OF TRANSPORTATION</p>	<p>BRIGGS ST. OVER HICKORY CREEK & METRA RAILROAD DECK SLAB REPAIR - SPAN 2</p>	FAU	SECTION	COUNTY	TOTAL	SHEET
	PLOT SCALE = NONE	CHECKED -- BAN	REVISED --			363	17-00053-19-FP	WILL	218	171
	PLOT DATE =	DRAWN -- JCW	REVISED --			S.N. 099-3324		CONTRACT NO.		
	CHECKED -- CTM/BAN	REVISED --	SHEET NO. 8 OF 23 SHEETS		ILLINOIS FED. AID PROJECT					

LEGEND

- Deck Slab Repair (Partial Depth)
- SF Square Feet

WEST PARAPET ELEVATION
(Looking West)

EAST PARAPET ELEVATION
(Looking East)

Notes:
Deck condition survey performed May 2019.
Repair of the existing deck shall include but not be limited to the areas shown. The actual areas to be repaired will be determined by the Engineer at the time of construction.
See sheet 20 of 23 for Bill of Materials.

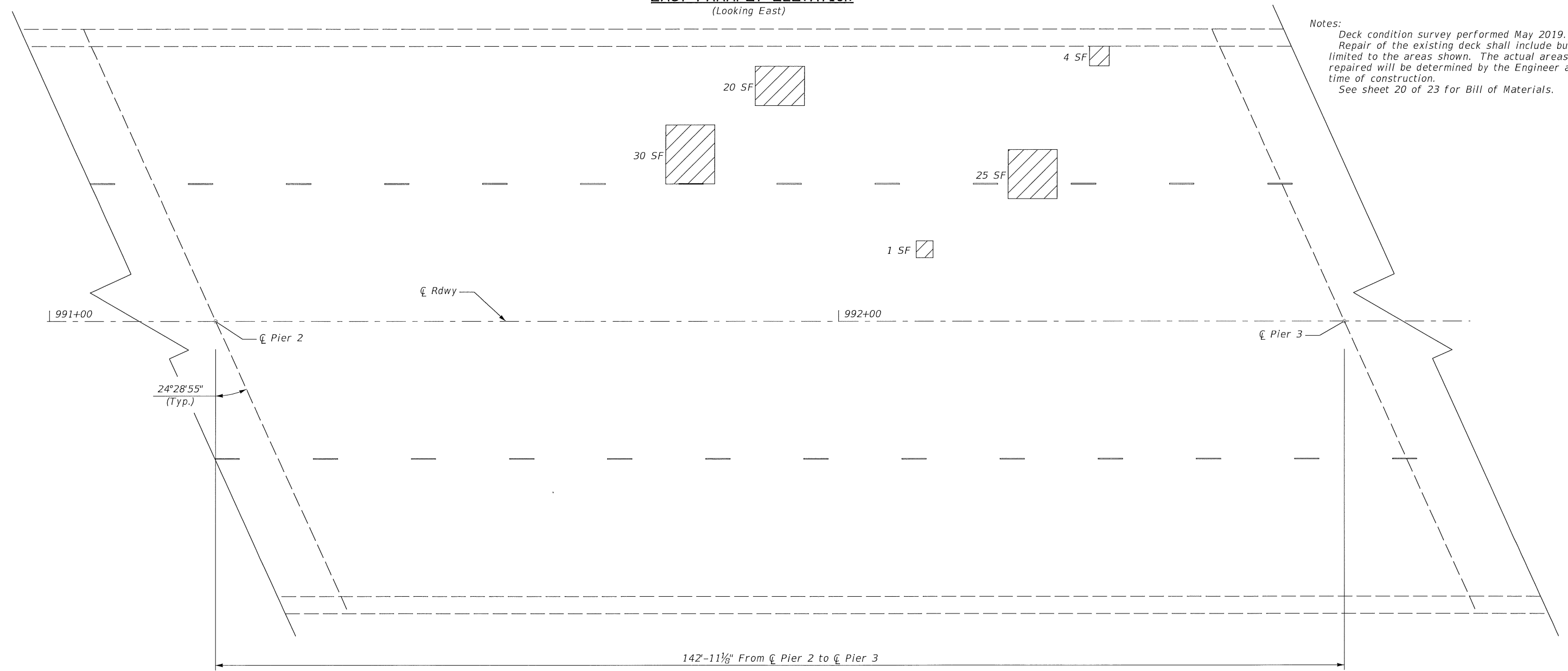

SPAN 3 PLAN



Note: All dimensions were taken from as built plans

Hutchison Engineering, Inc.
JACKSONVILLE-SHOREWOOD-PEORIA-MOLINE

USER NAME =	DESIGNED _ CTM	REVISED _
PLOT SCALE = NONE	CHECKED _ BAN	REVISED _
PLOT DATE =	DRAWN _ JCW	REVISED _
	CHECKED _ CTM/BAN	REVISED _

WILL COUNTY
DIVISION OF TRANSPORTATION

BRIGGS ST. OVER HICKORY CREEK & METRA RAILROAD
DECK SLAB REPAIR - SPAN 3

FAU RTE	SECTION	COUNTY	TOTAL SHEETS	SHEET NO.
363	17-00053-19-FP	WILL	218	172
S.N. 099-3324			CONTRACT NO.	
ILLINOIS FED. AID PROJECT				

SHEET NO. 9 OF 23 SHEETS

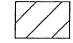
LEGEND
 Deck Slab Repair (Partial Depth)
 SF Square Feet

WEST PARAPET ELEVATION
 (Looking West)

EAST PARAPET ELEVATION
 (Looking East)

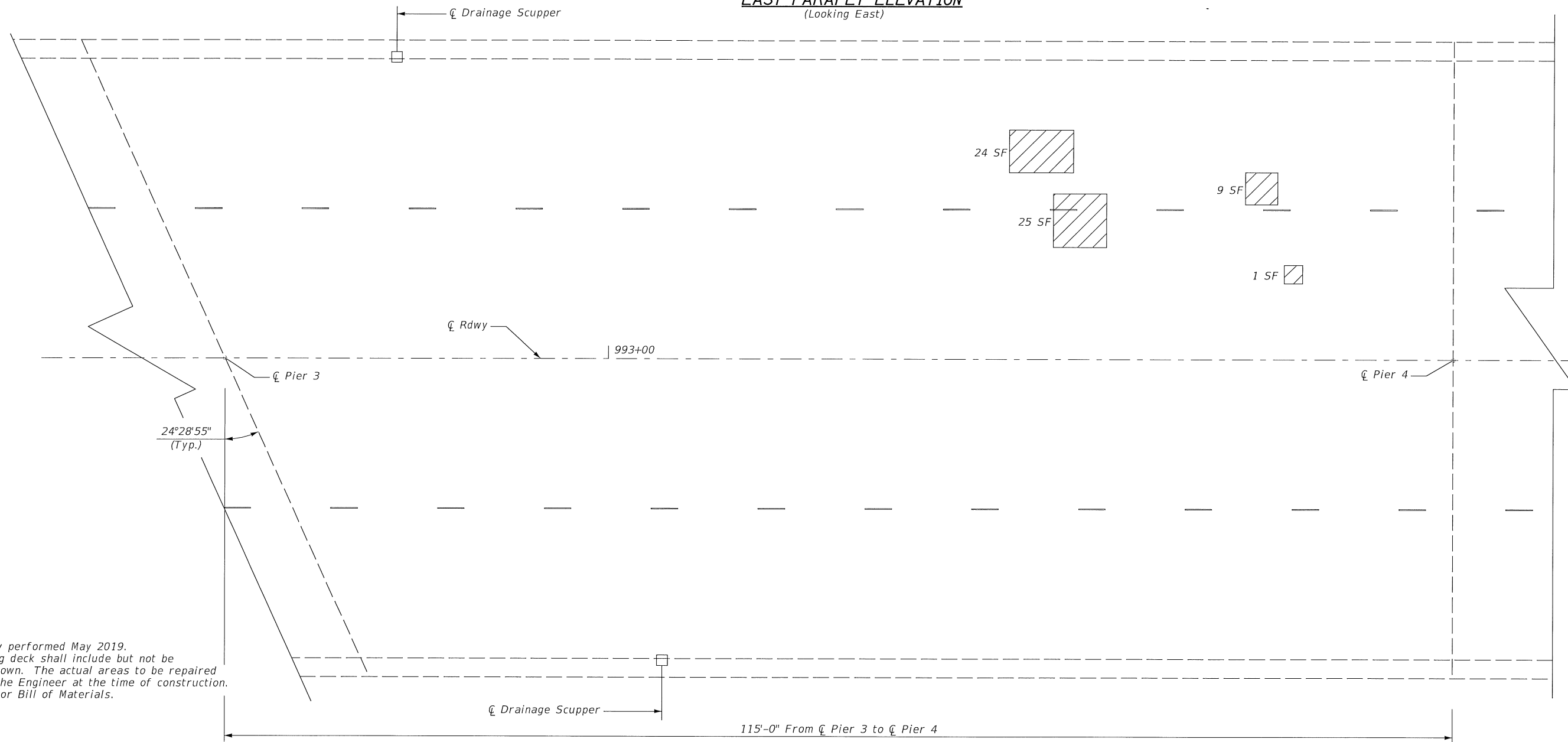

Notes:
 Deck condition survey performed May 2019.
 Repair of the existing deck shall include but not be limited to the areas shown. The actual areas to be repaired will be determined by the Engineer at the time of construction. See sheet 20 of 23 for Bill of Materials.

Note: All dimensions were taken from as built plans

SPAN 4 PLAN



Hutchison Engineering, Inc. JACKSONVILLE-SHOREWOOD-PEORIA-MOLINE	USER NAME =	DESIGNED - CTM	REVISED -	WILL COUNTY DIVISION OF TRANSPORTATION	BRIGGS ST. OVER HICKORY CREEK & METRA RAILROAD DECK SLAB REPAIR - SPAN 4	FAU	SECTION	COUNTY	TOTAL	SHEET
	PLOT SCALE = NONE	CHECKED - BAN	REVISED -			363	17-00053-19-FP	WILL	218	173
	PLOT DATE =	DRAWN - JCW	REVISED -			S.N. 099-3324		CONTRACT NO.		
	CHECKED - CTM/BAN	REVISED -	SHEET NO. 10 OF 23 SHEETS		ILLINOIS FED. AID PROJECT					

LEGEND

-  Deck Slab Repair (Partial Depth)
- SF Square Feet

WEST PARAPET ELEVATION
(Looking West)

EAST PARAPET ELEVATION
(Looking East)

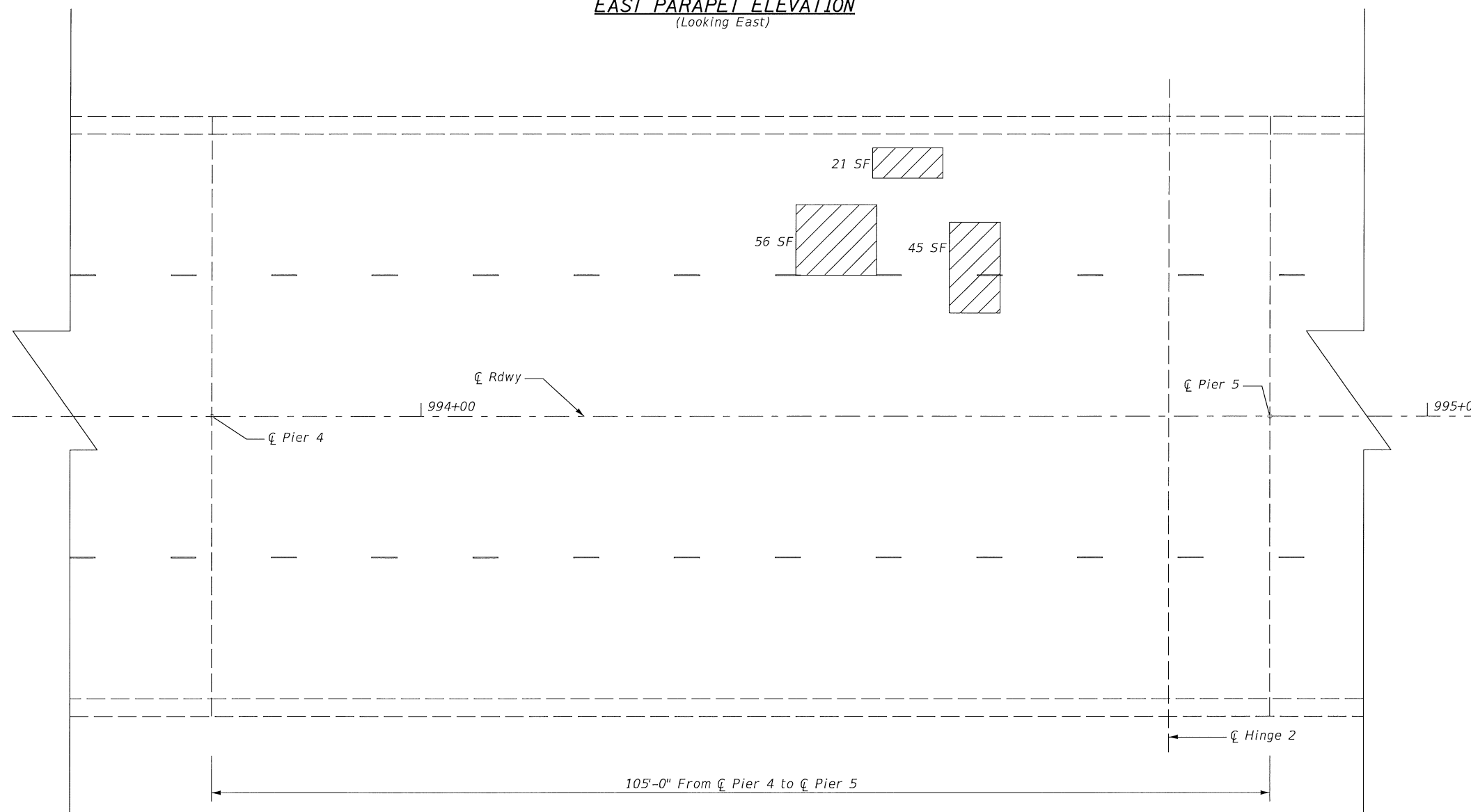

SPAN 5 PLAN

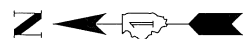

Note: All dimensions were taken from as built plans

Notes:
Deck condition survey performed May 2019.
Repair of the existing deck shall include but not be limited to the areas shown. The actual areas to be repaired will be determined by the Engineer at the time of construction. See sheet 20 of 23 for Bill of Materials.

Hutchison Engineering, Inc. JACKSONVILLE-SHOREWOOD-PEORIA-MOLINE	USER NAME =	DESIGNED _ CTM	REVISED _	WILL COUNTY DIVISION OF TRANSPORTATION	BRIGGS ST. OVER HICKORY CREEK & METRA RAILROAD DECK SLAB REPAIR - SPAN 5	FAU	SECTION	COUNTY	TOTAL	SHEET
	PLOT SCALE = NONE	CHECKED _ BAN	REVISED _			363	17-00053-19-FP	WILL	218	174
	PLOT DATE =	DRAWN _ JCW	REVISED _			S.N. 099-3324			CONTRACT NO.	
		CHECKED _ CTM/BAN	REVISED _			SHEET NO. 11 OF 23 SHEETS			ILLINOIS FED. AID PROJECT	

LEGEND

 Deck Slab Repair (Partial Depth)

SF Square Feet

WEST PARAPET ELEVATION
(Looking West)

EAST PARAPET ELEVATION
(Looking East)

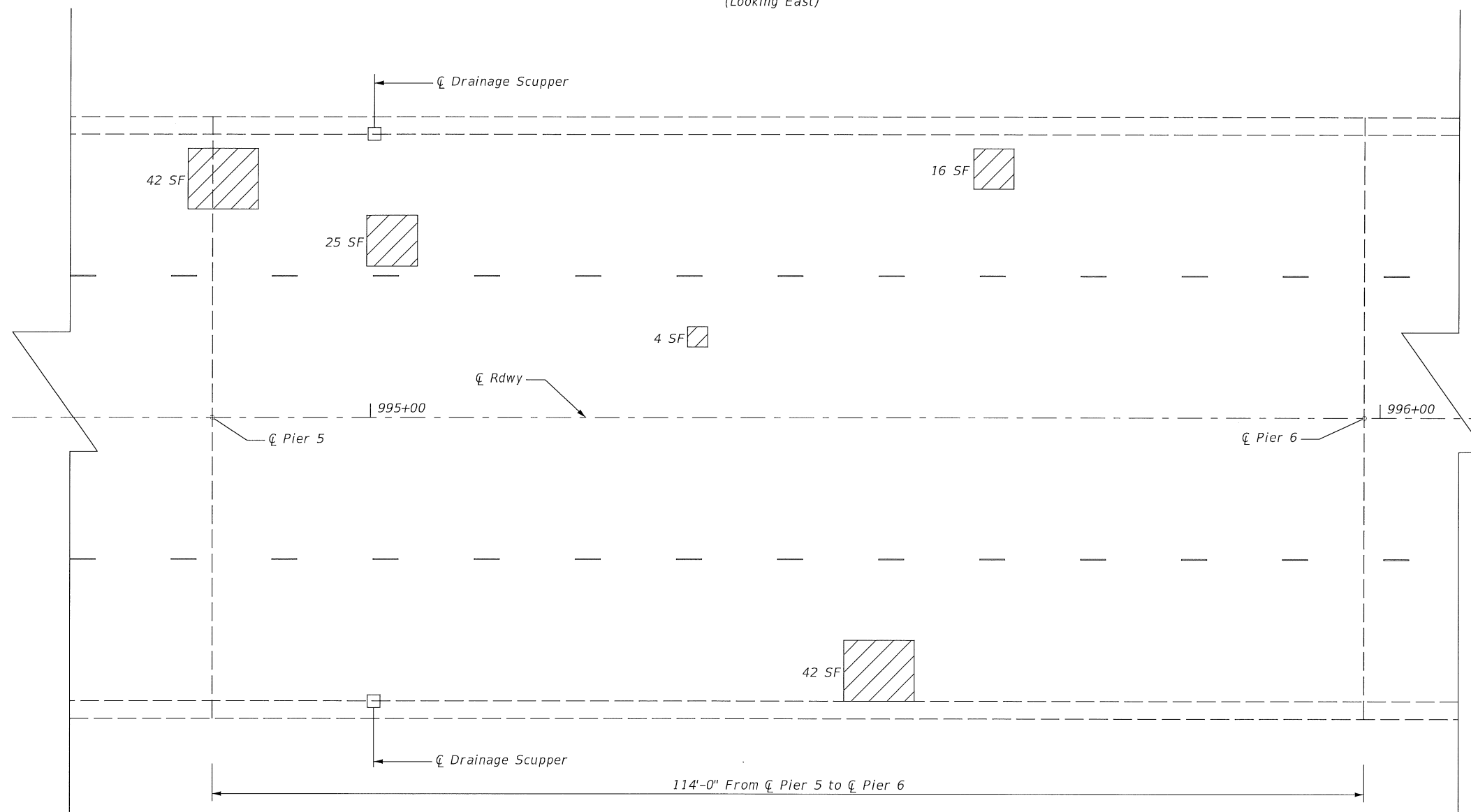

SPAN 6 PLAN

Notes:
Deck condition survey performed May 2019.
Repair of the existing deck shall include but not be limited to the areas shown. The actual areas to be repaired will be determined by the Engineer at the time of construction. See sheet 20 of 23 for Bill of Materials.

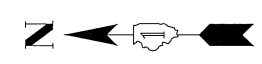

Note: All dimensions were taken from as built plans

Hutchison Engineering, Inc. JACKSONVILLE-SHOREWOOD-PEORIA-MOLINE	USER NAME =	DESIGNED -- CTM	REVISED --	WILL COUNTY DIVISION OF TRANSPORTATION	BRIGGS ST. OVER HICKORY CREEK & METRA RAILROAD DECK SLAB REPAIR - SPAN 6	FAU	SECTION	COUNTY	TOTAL	SHEET
	PLOT SCALE = NONE	CHECKED -- BAN	REVISED --			363	17-00053-19-FP	WILL	218	175
	PLOT DATE =	DRAWN -- JCW	REVISED --			S.N. 099-3324		CONTRACT NO.		
		CHECKED -- CTM/BAN	REVISED --			SHEET NO. 12 OF 23 SHEETS		[ILLINOIS] FED. AID PROJECT		

LEGEND

-  Deck Slab Repair (Partial Depth)
- SF Square Feet

WEST PARAPET ELEVATION
(Looking West)

EAST PARAPET ELEVATION
(Looking East)

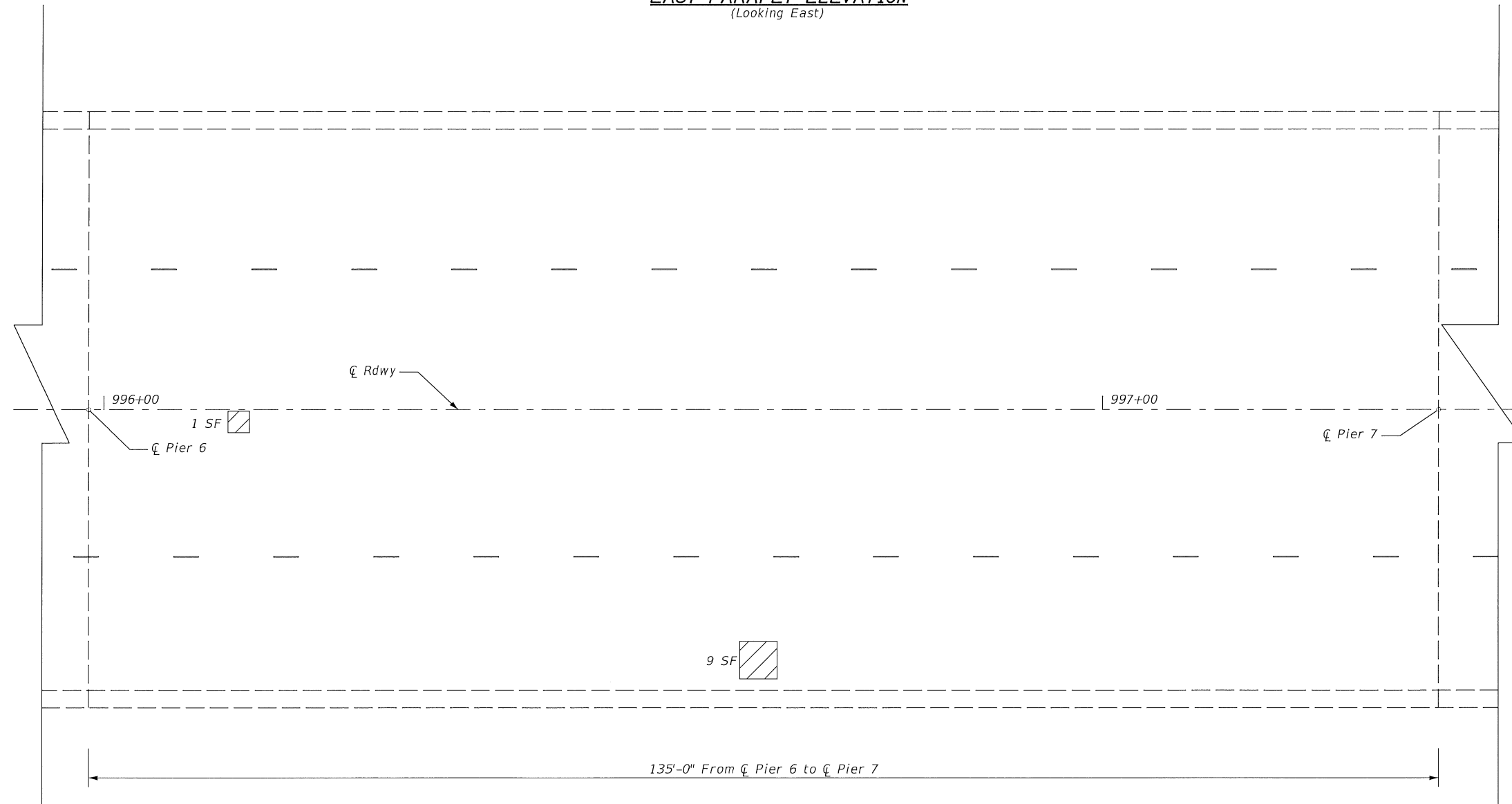

SPAN 7 PLAN

Notes:
Deck condition survey performed May 2019.
Repair of the existing deck shall include but not be limited to the areas shown. The actual areas to be repaired will be determined by the Engineer at the time of construction. See sheet 20 of 23 for Bill of Materials.



Note: All dimensions were taken from as built plans

Hutchison Engineering, Inc.
JACKSONVILLE-SHOREWOOD-PEORIA-MOLINE

USER NAME =	DESIGNED - CTM	REVISED -
PLOT SCALE = NONE	CHECKED - BAN	REVISED -
PLOT DATE =	DRAWN - JCW	REVISED -
	CHECKED - CTM/BAN	REVISED -

WILL COUNTY
DIVISION OF TRANSPORTATION

BRIGGS ST. OVER HICKORY CREEK & METRA RAILROAD
DECK SLAB REPAIR - SPAN 7

FAU RTE	SECTION	COUNTY	TOTAL SHEETS	SHEET NO.
363	17-00053-19-FP	WILL	218	176
S.N. 099-3324			CONTRACT NO.	

SHEET NO. 13 OF 23 SHEETS

[ILLINOIS] FED. AID PROJECT

LEGEND

-  Deck Slab Repair (Partial Depth)
- SF Square Feet

WEST PARAPET ELEVATION
(Looking West)

EAST PARAPET ELEVATION
(Looking East)

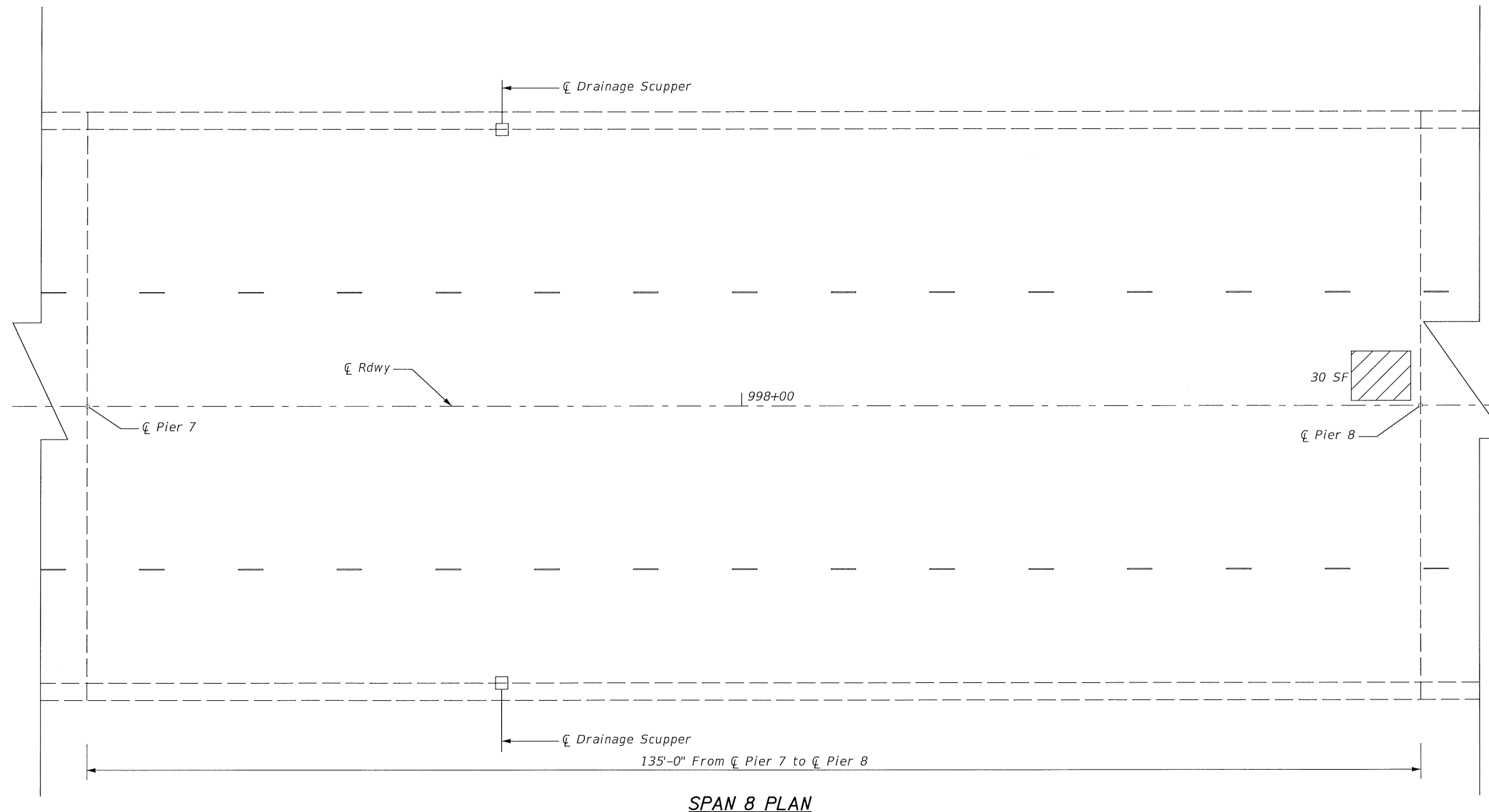

SPAN 8 PLAN

Notes:
 Deck condition survey performed May 2019.
 Repair of the existing deck shall include but not be limited to the areas shown. The actual areas to be repaired will be determined by the Engineer at the time of construction. See sheet 20 of 23 for Bill of Materials.



Note: All dimensions were taken from as built plans

Hutchison Engineering, Inc. JACKSONVILLE-SHOREWOOD-PEORIA-MOLINE	USER NAME =	DESIGNED - CTM	REVISED -	WILL COUNTY DIVISION OF TRANSPORTATION	BRIGGS ST. OVER HICKORY CREEK & METRA RAILROAD DECK SLAB REPAIR - SPAN 8	FAU	SECTION	COUNTY	TOTAL	SHEET
	PLOT SCALE = NONE	CHECKED - BAN	REVISED -			363	17-00053-19-FP	WILL	218	177
	PLOT DATE =	DRAWN - JCW	REVISED -			S.N. 099-3324		CONTRACT NO.		
	CHECKED - CTM/BAN	REVISED -	SHEET NO. 14 OF 23 SHEETS			ILLINOIS FED. AID PROJECT				

LEGEND
 Deck Slab Repair (Partial Depth)
 SF Square Feet

WEST PARAPET ELEVATION
 (Looking West)

EAST PARAPET ELEVATION
 (Looking East)

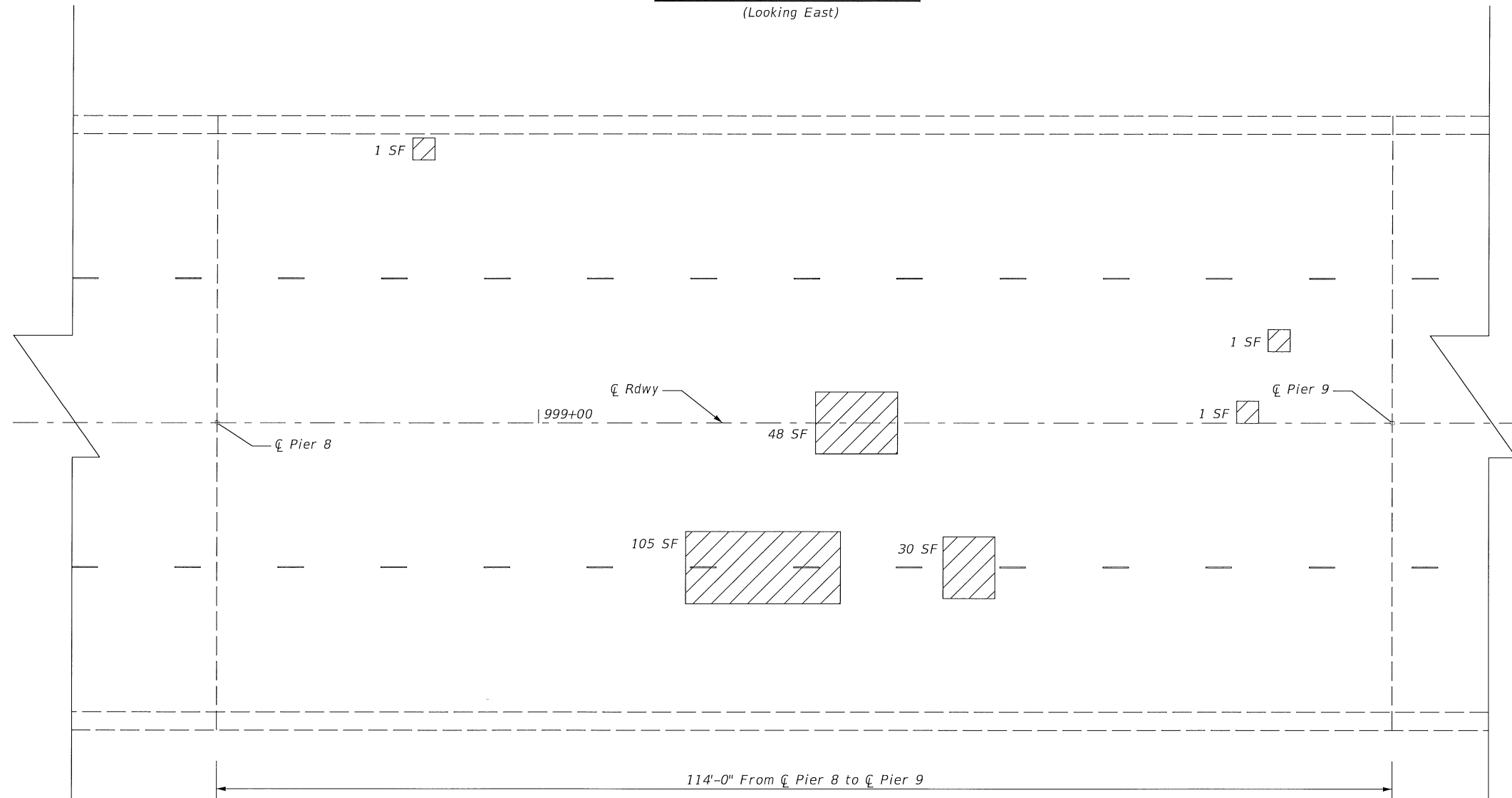

SPAN 9 PLAN

Notes:
 Deck condition survey performed May 2019.
 Repair of the existing deck shall include but not be limited to the areas shown. The actual areas to be repaired will be determined by the Engineer at the time of construction. See sheet 20 of 23 for Bill of Materials.



Note: All dimensions were taken from as built plans

Hutchison Engineering, Inc.
 JACKSONVILLE-SHOREWOOD-PEORIA-MOLINE

USER NAME =	DESIGNED - CTM	REVISED -
PLOT SCALE = NONE	CHECKED - BAN	REVISED -
PLOT DATE =	DRAWN - JCW	REVISED -
	CHECKED - CTM/BAN	REVISED -

WILL COUNTY
DIVISION OF TRANSPORTATION

BRIGGS ST. OVER HICKORY CREEK & METRA RAILROAD
DECK SLAB REPAIR - SPAN 9

FAU RTE	SECTION	COUNTY	TOTAL SHEETS	SHEET NO.
363	17-00053-19-FP	WILL	218	178
S.N. 099-3324			CONTRACT NO.	

SHEET NO. 15 OF 23 SHEETS

ILLINOIS FED. AID PROJECT

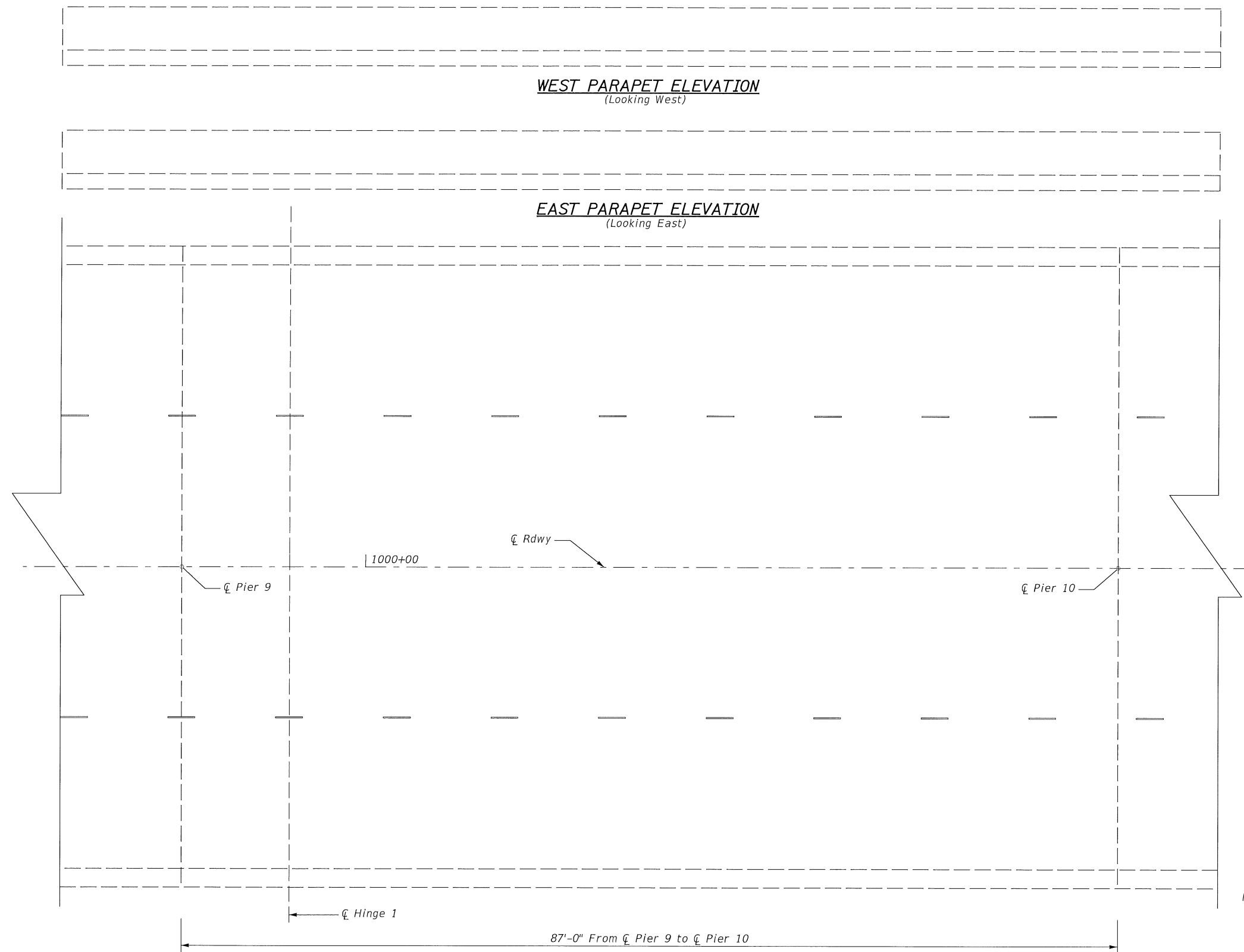

LEGEND
 Deck Slab Repair (Partial Depth)
 SF Square Feet

Notes:
 Deck condition survey performed May 2019.
 Repair of the existing deck shall include but not be limited to the areas shown. The actual areas to be repaired will be determined by the Engineer at the time of construction. See sheet 20 of 23 for Bill of Materials.



Note: All dimensions were taken from as built plans

SPAN 10 PLAN

Hutchison Engineering, Inc. JACKSONVILLE-SHOREWOOD-PEORIA-MOLINE	USER NAME =	DESIGNED - CTM	REVISED -	WILL COUNTY DIVISION OF TRANSPORTATION	BRIGGS ST. OVER HICKORY CREEK & METRA RAILROAD DECK SLAB REPAIR - SPAN 10	FAU	SECTION	COUNTY	TOTAL	SHEET
	PLOT SCALE = NONE	CHECKED - BAN	REVISED -			363	17-00053-19-FP	WILL	218	179
	PLOT DATE =	DRAWN - JCW	REVISED -			S.N. 099-3324		CONTRACT NO.		
		CHECKED - CTM/BAN	REVISED -			SHEET NO. 16 OF 23 SHEETS		[ILLINOIS] FED. AID PROJECT		

LEGEND

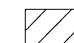
-  Deck Slab Repair (Partial Depth)
- SF Square Feet

WEST PARAPET ELEVATION
(Looking West)

EAST PARAPET ELEVATION
(Looking East)

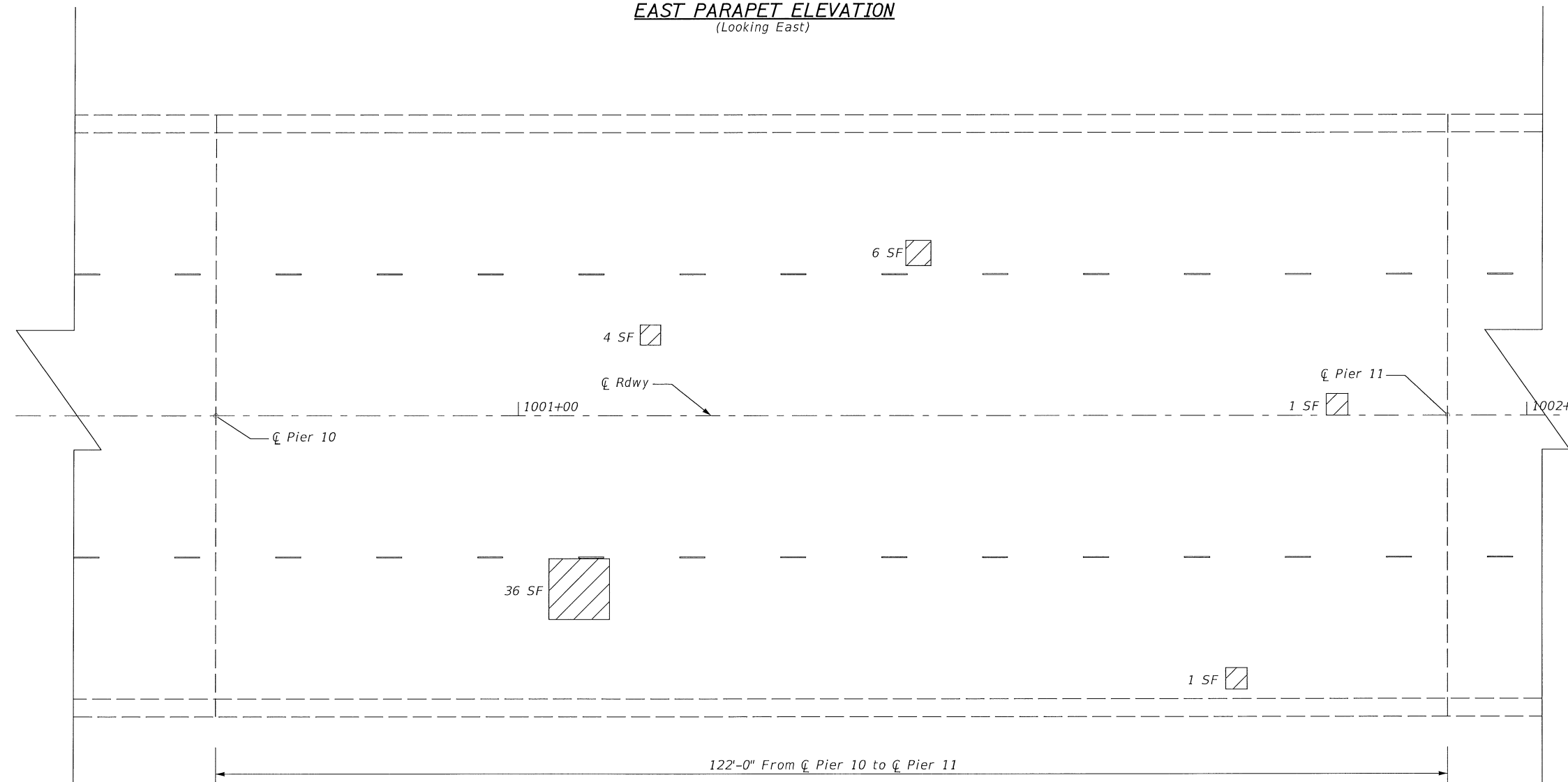

SPAN 11 PLAN

Notes:
Deck condition survey performed May 2019.
Repair of the existing deck shall include but not be limited to the areas shown. The actual areas to be repaired will be determined by the Engineer at the time of construction.
See sheet 20 of 23 for Bill of Materials.



Note: All dimensions were taken from as built plans

Hutchison Engineering, Inc. JACKSONVILLE-SHOREWOOD-PEORIA-MOLINE	USER NAME =	DESIGNED - CTM	REVISED -	WILL COUNTY DIVISION OF TRANSPORTATION	BRIGGS ST. OVER HICKORY CREEK & METRA RAILROAD DECK SLAB REPAIR - SPAN 11	FAU	SECTION	COUNTY	TOTAL	SHEET
	PLOT SCALE = NONE	CHECKED - BAN	REVISED -			363	17-00053-19-FP	WILL	218	180
	PLOT DATE =	DRAWN - JCW	REVISED -			S.N. 099-3324		CONTRACT NO.		
	CHECKED - CTM/BAN	REVISED -	SHEET NO. 17 OF 23 SHEETS			ILLINOIS FED. AID PROJECT				

LEGEND

-  Deck Slab Repair (Partial Depth)
- SF Square Feet

WEST PARAPET ELEVATION
(Looking West)

EAST PARAPET ELEVATION
(Looking East)

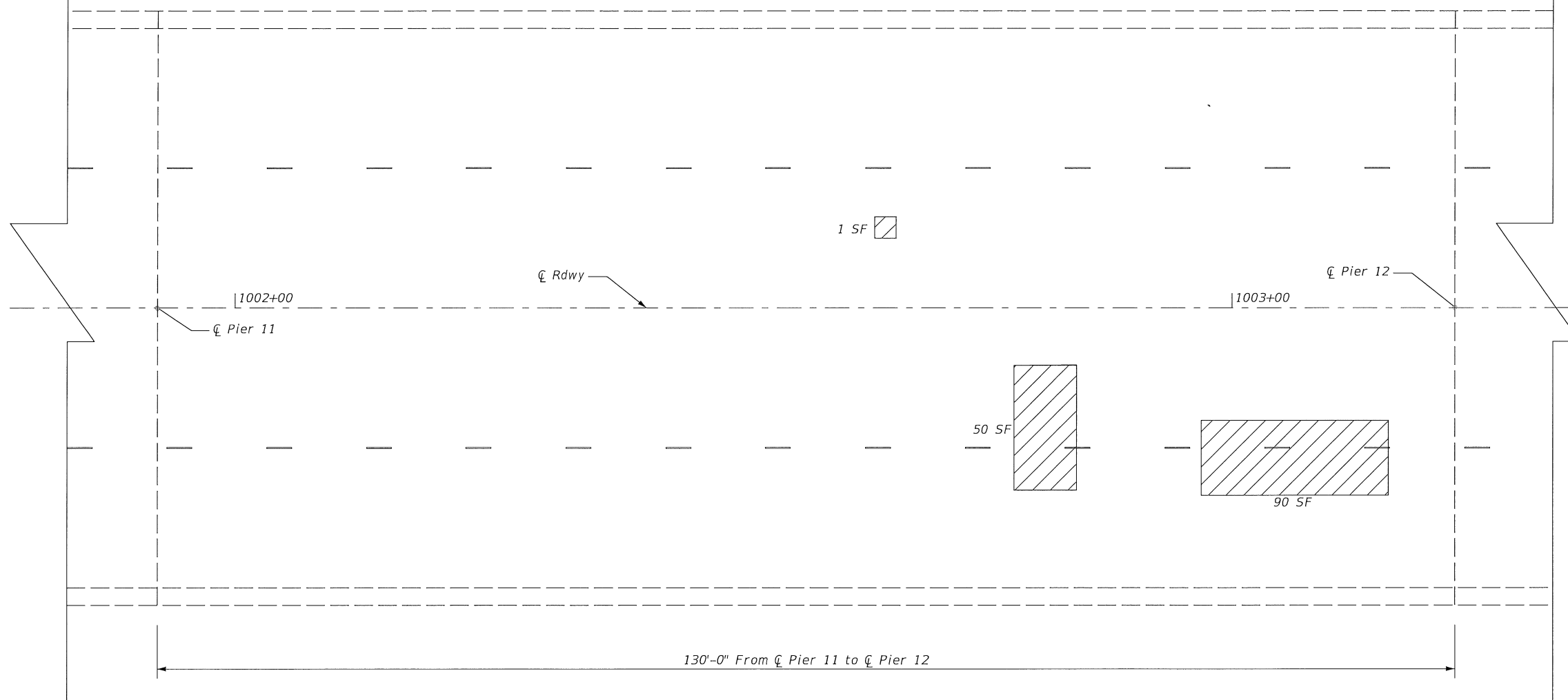

SPAN 12 PLAN

Notes:
Deck condition survey performed May 2019.
Repair of the existing deck shall include but not be limited to the areas shown. The actual areas to be repaired will be determined by the Engineer at the time of construction. See sheet 20 of 23 for Bill of Materials.



Note: All dimensions were taken from as built plans

Hutchison Engineering, Inc. JACKSONVILLE-SHOREWOOD-PEORIA-MOLINE	USER NAME =	DESIGNED - CTM	REVISED -	WILL COUNTY DIVISION OF TRANSPORTATION	BRIGGS ST. OVER HICKORY CREEK & METRA RAILROAD DECK SLAB REPAIR - SPAN 12	FAU	SECTION	COUNTY	TOTAL	SHEET
	PLOT SCALE = NONE	CHECKED - BAN	REVISED -			363	17-00053-19-FP	WILL	218	181
	PLOT DATE =	DRAWN - JCW	REVISED -			S.N. 099-3324		CONTRACT NO.		
		CHECKED - CTM/BAN	REVISED -			SHEET NO. 18 OF 23 SHEETS		ILLINOIS FED. AID PROJECT		

LEGEND

-  Deck Slab Repair (Partial Depth)
- SF Square Feet

WEST PARAPET ELEVATION
(Looking West)

EAST PARAPET ELEVATION
(Looking East)

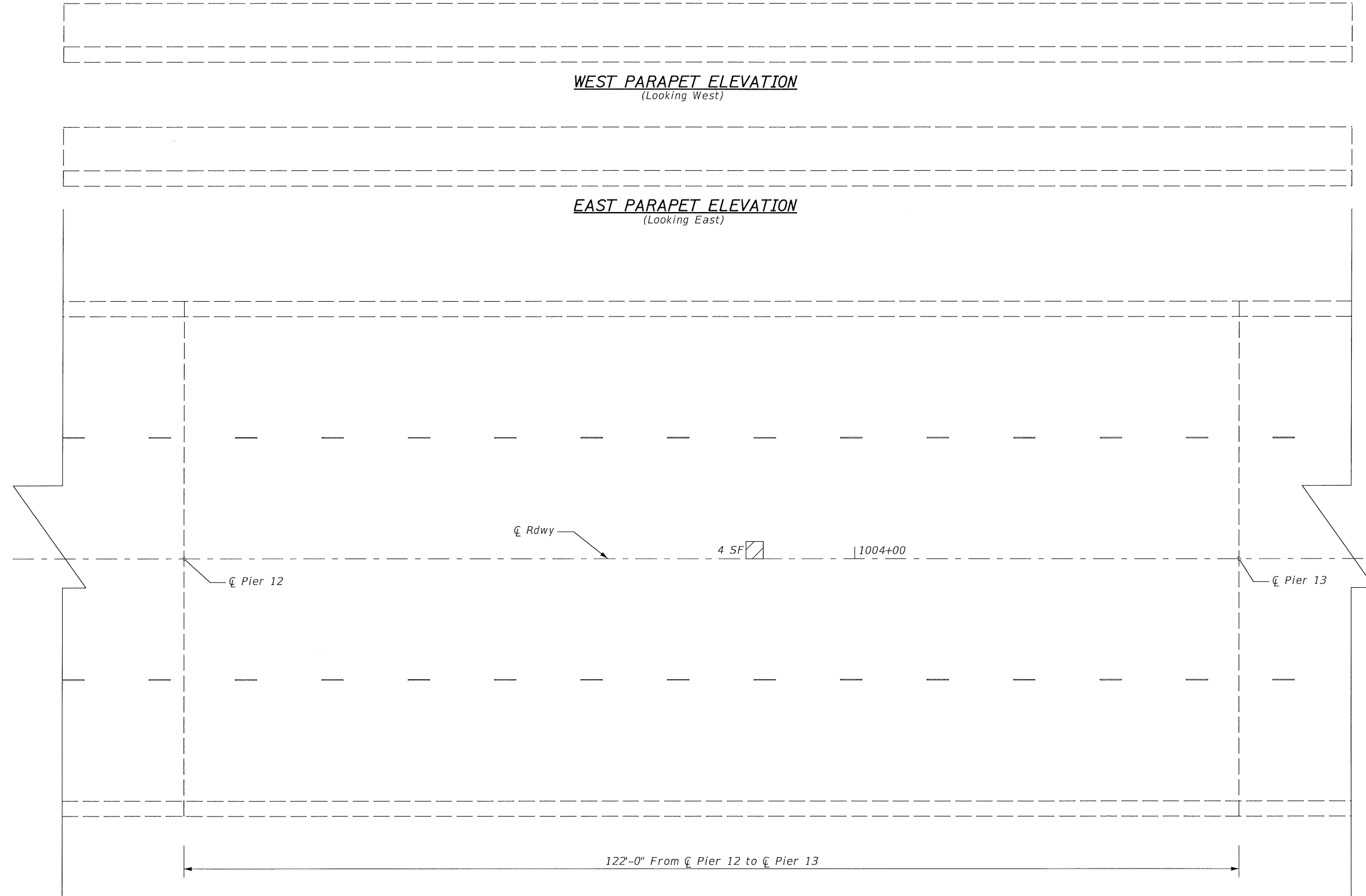

SPAN 13 PLAN

Notes:
Deck condition survey performed May 2019.
Repair of the existing deck shall include but not be limited to the areas shown. The actual areas to be repaired will be determined by the Engineer at the time of construction.
See sheet 20 of 23 for Bill of Materials.



Note: All dimensions were taken from as built plans

Hutchison Engineering, Inc. JACKSONVILLE-SHOREWOOD-PEORIA-MOLINE	USER NAME =	DESIGNED - CTM	REVISED -	WILL COUNTY DIVISION OF TRANSPORTATION	BRIGGS ST. OVER HICKORY CREEK & METRA RAILROAD DECK SLAB REPAIR - SPAN 13	FAU	SECTION	COUNTY	TOTAL	SHEET
	PLOT SCALE = NONE	CHECKED - BAN	REVISED -			363	17-00053-19-FP	WILL	218	182
	PLOT DATE =	DRAWN - JCW	REVISED -			S.N. 099-3324			CONTRACT NO.	
		CHECKED - CTM/BAN	REVISED -			SHEET NO. 19 OF 23 SHEETS			ILLINOIS FED. AID PROJECT	

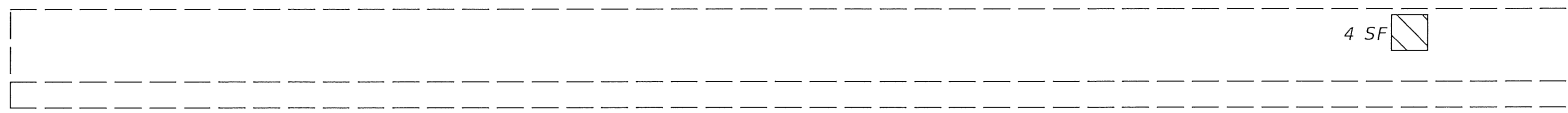

WEST PARAPET ELEVATION
(Looking West)



EAST PARAPET ELEVATION
(Looking East)

LEGEND

	Deck Slab Repair (Partial Depth)
	Structural Repair of Concrete (Depth Equal or Less Than 5 Inches)
SF	Square Feet

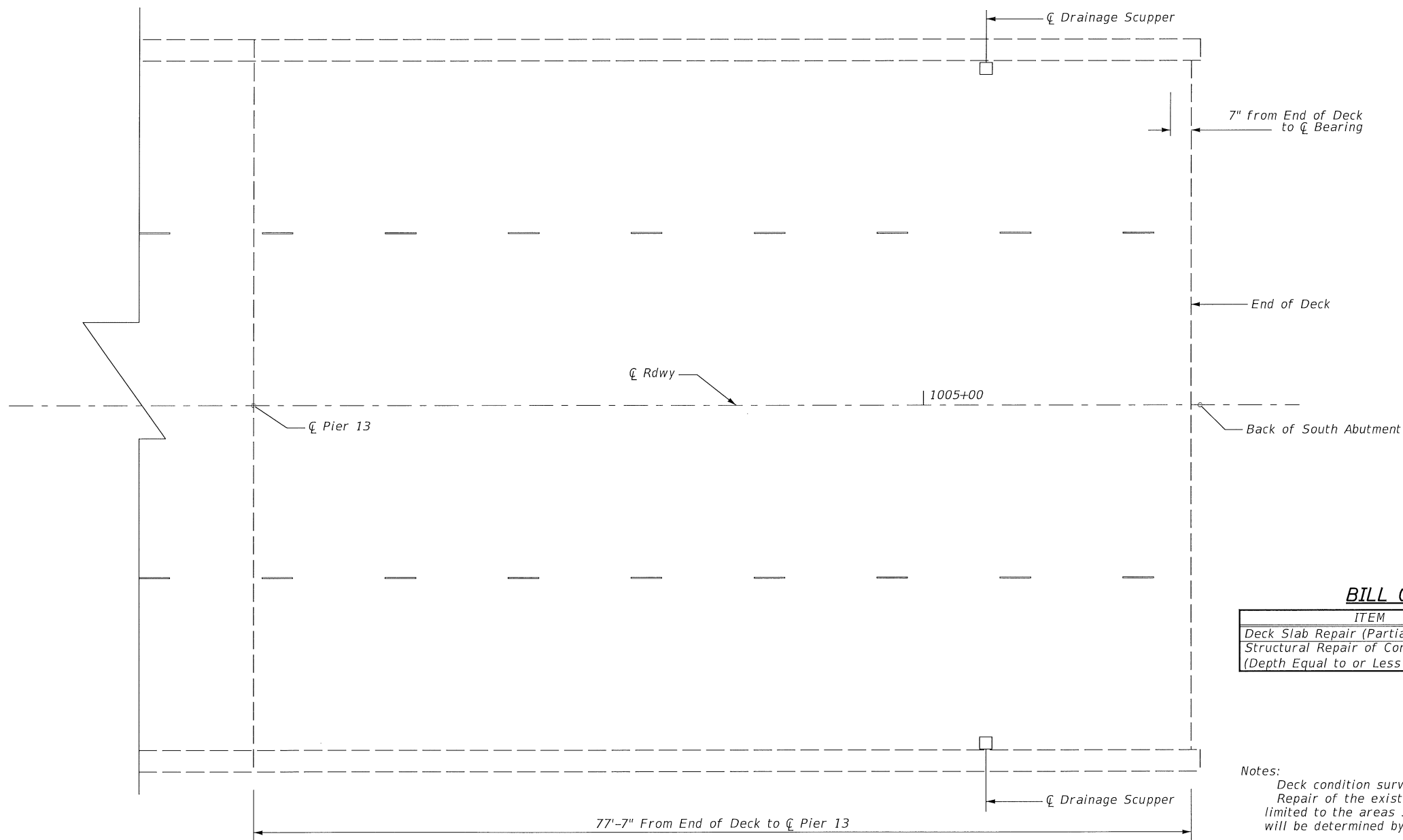

BILL OF MATERIAL

ITEM	UNIT	QUANTITY
Deck Slab Repair (Partial Depth)	SQ YD	109
Structural Repair of Concrete (Depth Equal to or Less Than 5 Inches)	SQ FT	6

Notes:
Deck condition survey performed May 2019.
Repair of the existing deck shall include but not be limited to the areas shown. The actual areas to be repaired will be determined by the Engineer at the time of construction.



Note: All dimensions were taken from as built plans

SPAN 14 PLAN

Hutchison Engineering, Inc. JACKSONVILLE-SHOREWOOD-PEORIA-MOLINE	USER NAME =	DESIGNED - CTM	REVISED -	WILL COUNTY DIVISION OF TRANSPORTATION	BRIGGS ST. OVER HICKORY CREEK & METRA RAILROAD DECK SLAB REPAIR - SPAN 14	FAU RTE	SECTION	COUNTY	TOTAL SHEETS	SHEET NO.
	PLOT SCALE = NONE	CHECKED - BAN	REVISED -			363	17-00053-19-FP	WILL	218	183
	PLOT DATE =	DRAWN - JCW	REVISED -			CONTRACT NO.				
	CHECKED - CTM/BAN	REVISED -	S.N. 099-3324							
SHEET NO. 20 OF 23 SHEETS						ILLINOIS FED. AID PROJECT				

LEGEND

 Structural Repair of Concrete
 (Depth Equal to or Lesser than 5 Inches)
 SF Square Feet

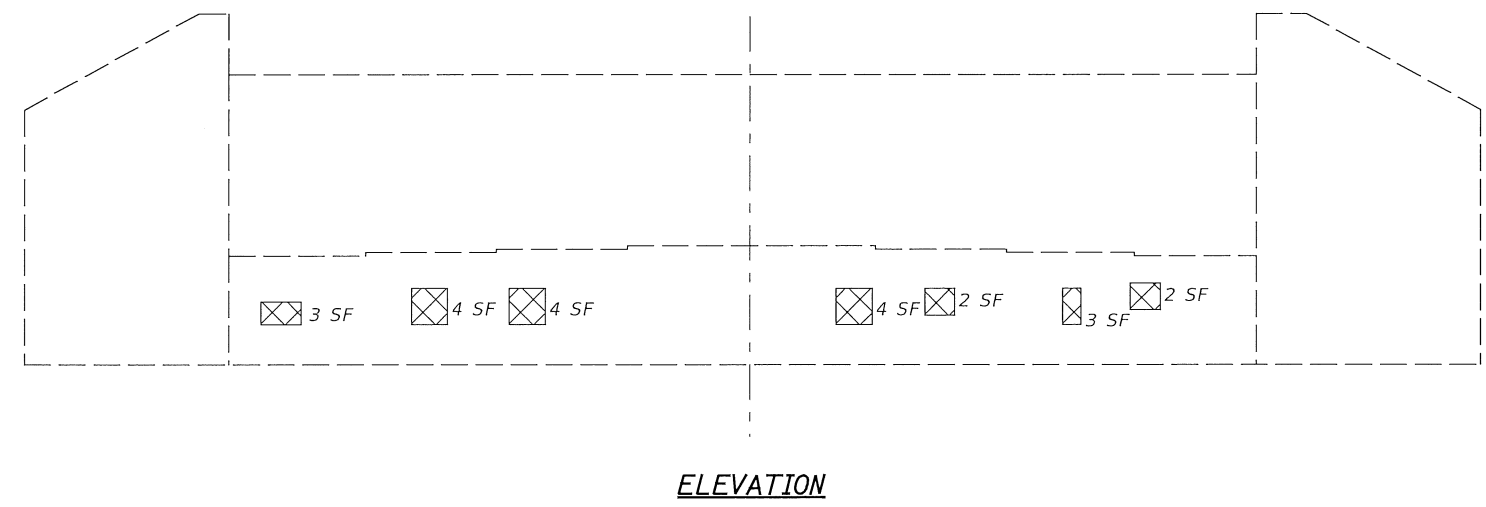
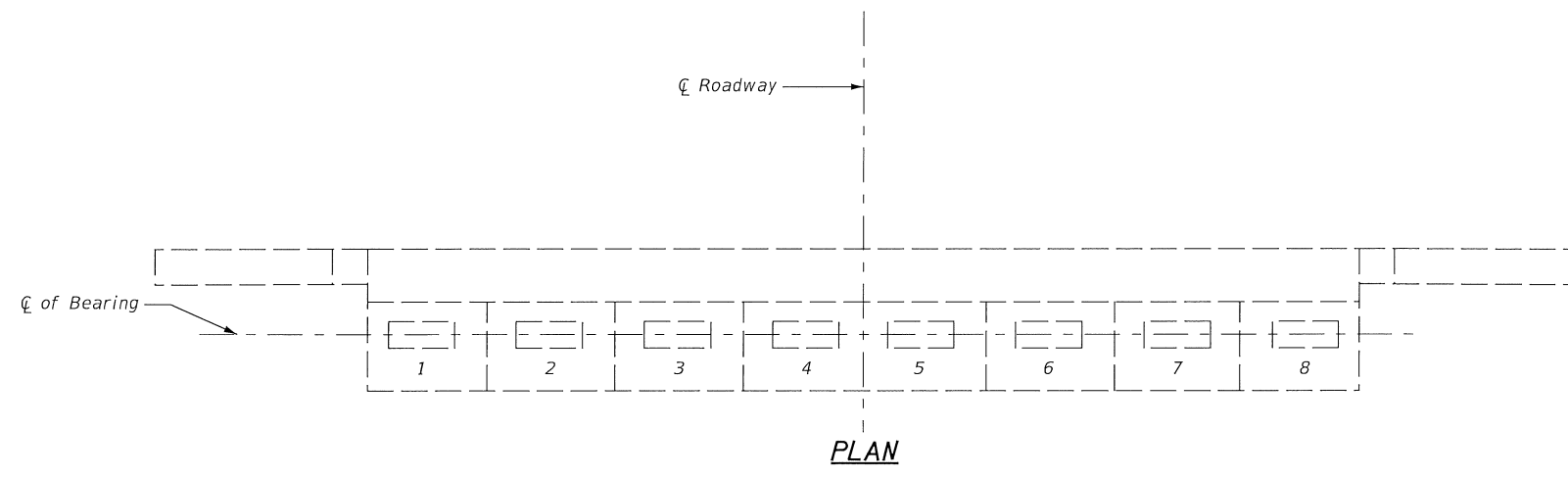

BILL OF MATERIAL

ITEM	UNIT	QUANTITY
Structural Repair of Concrete (Depth Equal to or Lesser than 5 Inches)	SQ FT	22

Hutchison Engineering, Inc.
 JACKSONVILLE-SHOREWOOD-PEORIA-MOLINE

USER NAME =	DESIGNED - CTM	REVISED -
PLOT SCALE = NONE	CHECKED - BAN	REVISED -
PLOT DATE =	DRAWN - JCW	REVISED -
	CHECKED - CTM/BAN	REVISED -

WILL COUNTY
DIVISION OF TRANSPORTATION

BRIGGS ST. OVER HICKORY CREEK & METRA RAILROAD
NORTH ABUTMENT REPAIRS

FAU RTE 363	SECTION 17-00053-19-FP	COUNTY WILL	TOTAL SHEETS 218	SHEET NO. 184
S.N. 099-3324			CONTRACT NO.	
ILLINOIS FED. AID PROJECT				

SHEET NO. 21 OF 23 SHEETS

LEGEND

-  Structural Repair of Concrete
(Depth Equal to or Lesser than 5 Inches)
- SF Square Feet

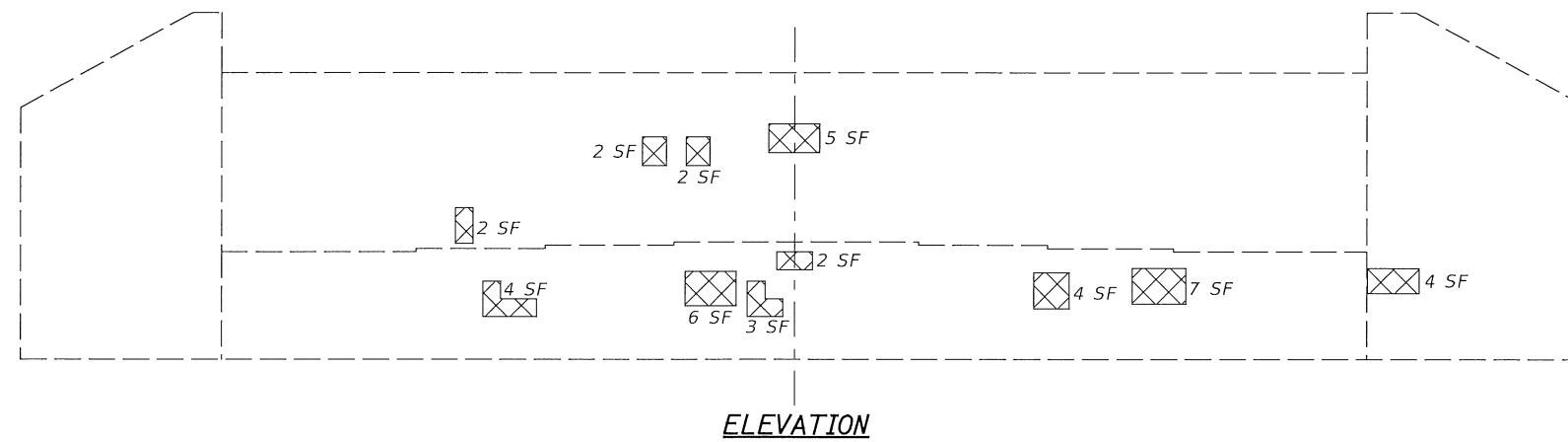
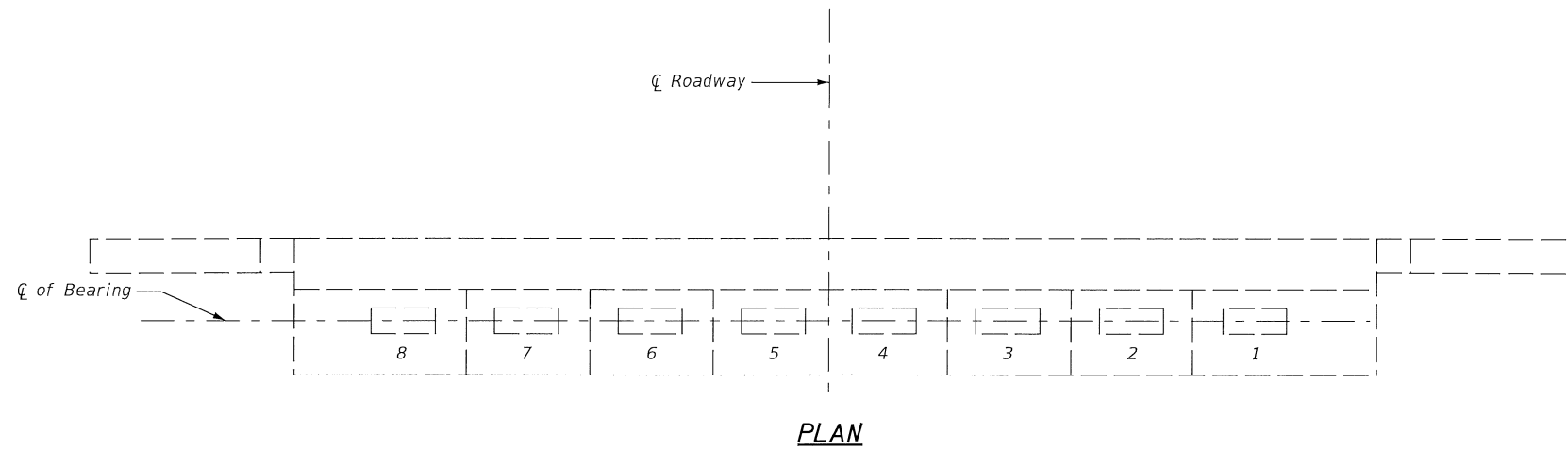

BILL OF MATERIAL

ITEM	UNIT	QUANTITY
Structural Repair of Concrete (Depth Equal to or Lesser than 5 Inches)	SQ FT	41

Hutchison Engineering, Inc. <small>JACKSONVILLE-SHOREWOOD-PEORIA-MOLINE</small>	USER NAME =	DESIGNED _ CTM	REVISED _	WILL COUNTY DIVISION OF TRANSPORTATION	BRIGGS ST. OVER HICKORY CREEK & METRA RAILROAD SOUTH ABUTMENT REPAIRS	FAU	SECTION	COUNTY	TOTAL	SHEET
	PLOT SCALE = NONE	CHECKED _ BAN	REVISED _			363	17-00053-19-FP	WILL	218	185
	PLOT DATE =	DRAWN _ JCW	REVISED _			S.N. 099-3324			CONTRACT NO.	
		CHECKED _ CTM/BAN	REVISED _			SHEET NO. 22 OF 23 SHEETS			ILLINOIS FED. AID PROJECT	

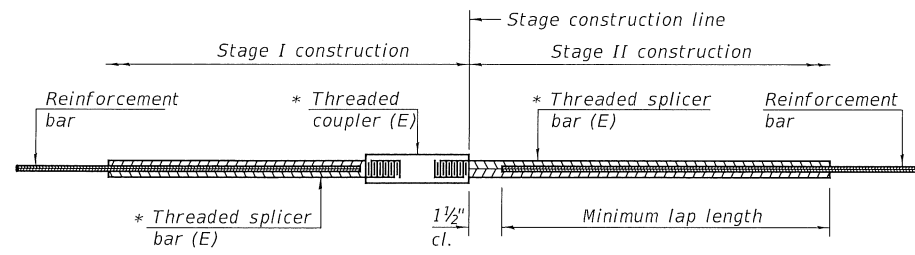

STANDARD BAR SPLICER ASSEMBLY

Threaded splicer bar length = min. lap length + 1 1/2" + thread length

* Epoxy not required on Bar Splicer Assembly components used in conjunction with black bars.

Location	Bar size	No. assemblies required	Minimum lap length
N. Abut.	#5	4	2'-7"
S. Abut.	#5	4	2'-7"

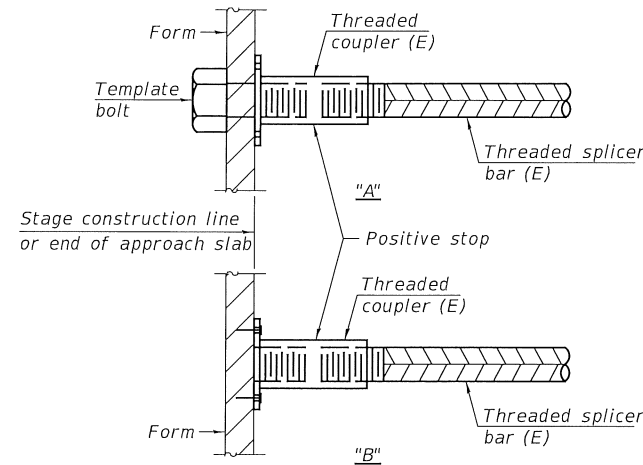

INSTALLATION AND SETTING METHODS

"A" : Set bar splicer assembly by means of a template bolt.
 "B" : Set bar splicer assembly by nailing to wood forms or cementing to steel forms.
 (E) : Indicates epoxy coating.

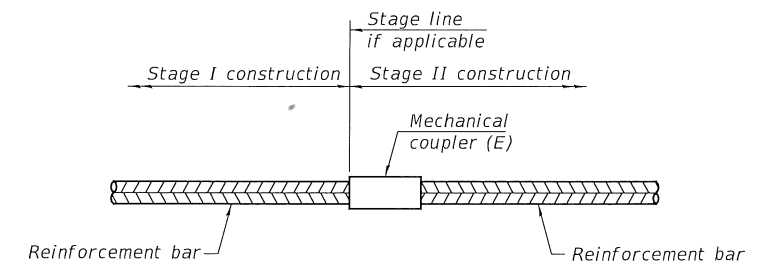

STANDARD MECHANICAL SPLICER

Location	Bar size	No. assemblies required

NOTES

Splicer bars shall be deformed with threaded ends and have a minimum 60 ksi yield strength.
 All reinforcement shall be lapped and tied to the splicer bars.
 Bar splicer assemblies shall be epoxy coated according to the requirements for reinforcement bars. See Section 508 of the Standard Specifications.
 See approved list of bar splicer assemblies and mechanical splicers for alternatives.

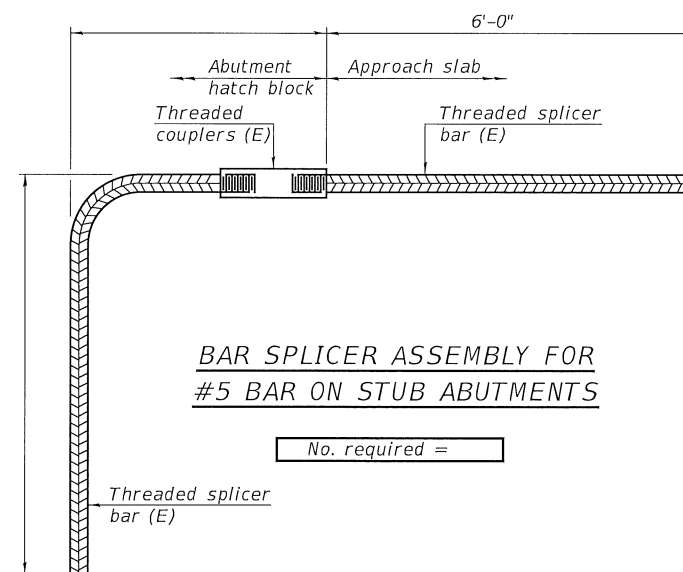

BAR SPLICER ASSEMBLY FOR #5 BAR ON STUB ABUTMENTS

No. required =

BSD-1 2-17-2017

Hutchison Engineering, Inc.
 JACKSONVILLE-SHOREWOOD-PEORIA-MOLINE

USER NAME =	DESIGNED - JOH	REVISED -
PLOT SCALE = NONE	CHECKED - BAN	REVISED -
PLOT DATE =	DRAWN - JCW	REVISED -
	CHECKED - JOH/BAN	REVISED -

**WILL COUNTY
 DIVISION OF TRANSPORTATION**

**BRIGGS ST. OVER HICKORY CREEK & METRA RAILROAD
 BAR SPLICER ASSEMBLY AND MECHANICAL SPLICER DETAILS**

FAU RTE	SECTION	COUNTY	TOTAL SHEETS	SHEET NO.
363	17-00053-19-FP	WILL	218	186
S.N. 099-3324			CONTRACT NO.	

SHEET NO. 23 OF 23 SHEETS

ILLINOIS FED. AID PROJECT